

JIELIWEI METAL PRODUCTS

佛山市捷力威金属制品有限公司

Extrusion Mold



CONTENTS

01

About Us

02

Our Team

03

Equipment

04

**Product
Categories**

05

**Contact
Us**



01 ABOUT US

Jieliwei Metal Products Co., Ltd., formerly known as Jieliwei Hardware Processing Factory, was established in October 2006 and was registered and upgraded to Foshan Jieliwei Metal Products Co., Ltd. in 2020. The company is located in Sanshui District, Foshan City, Guangdong Province, covering an area of 7,000 square meters and currently employs 200 employees.

The company mainly produces aluminum profile extrusion dies, with a complete mold design, mold programming, and professional product development team. Moreover, the mold production process is mature (15 production processes such as blanking, lathe, machining center, wire cutting, EDM, heat treatment, slow wire walking, etc.), and we have a complete team of after-sales services.

The company's mold design and processing technology has obtained patents for many times, and has been rated as a high-tech enterprise in Foshan City. The monthly production capacity is 5,000 to 6,000 sets. The main products are: industrial products, radiators, sun rooms, building materials, automobiles, solar panels, bathroom aluminum molds, etc.



Establish



Develop



Enhance

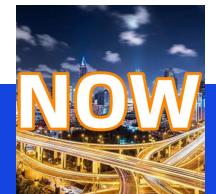

Strengthen

02 OUR TEAM





Equipment

PROCESSING



Aluminum Profile Extrusion Mold

03



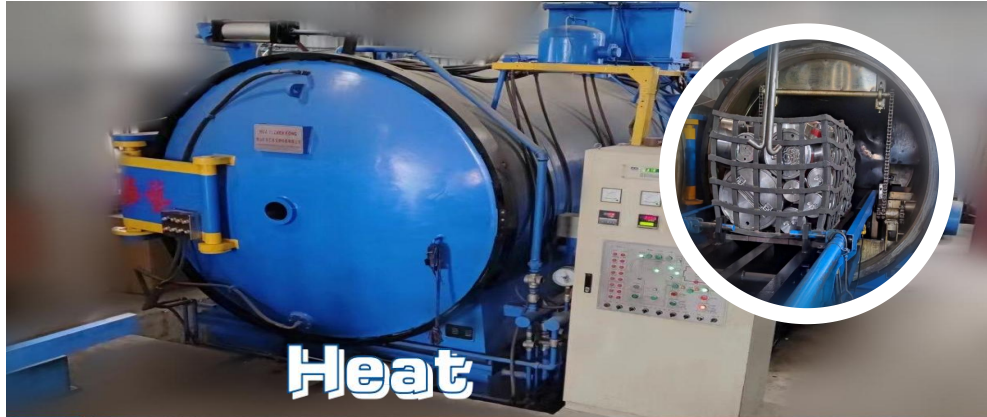

**Heat
Treatment**



Polishing

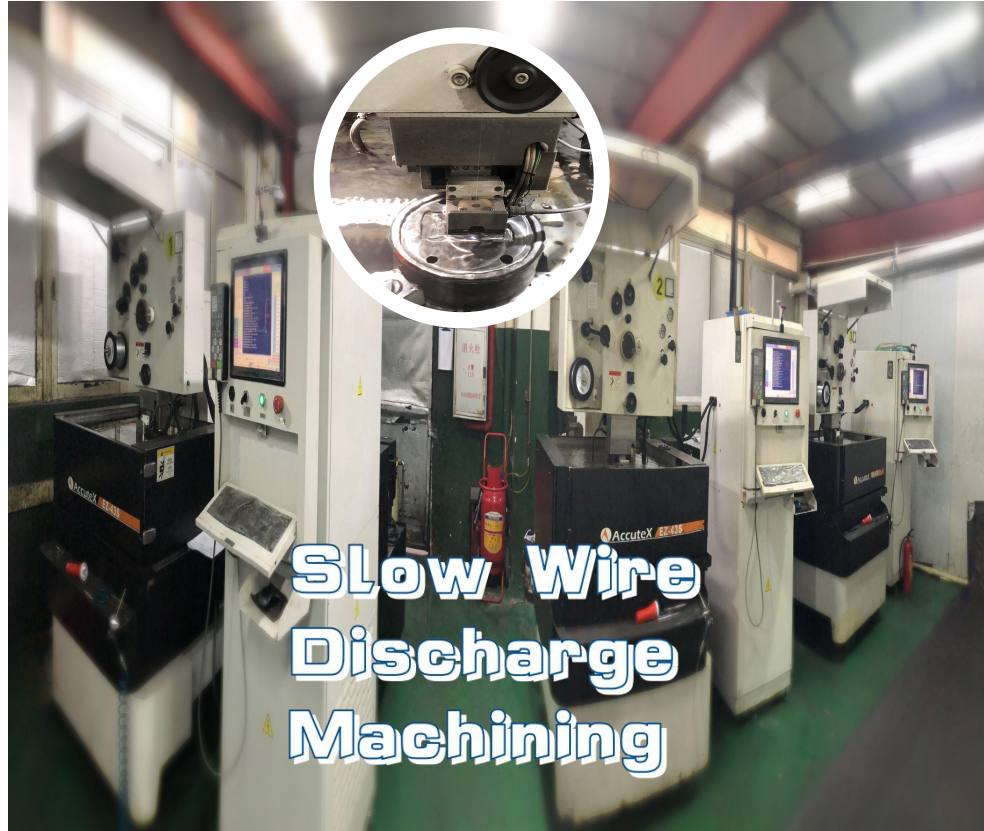

**Slow Wire
Discharge
Machining**



**Wire
Discharge
Machining**

PRODUCT CATEGORIES

WHATEVER YOU WANT

Aluminum Profile Extrusion Mold

04

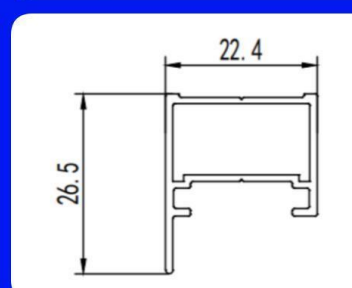
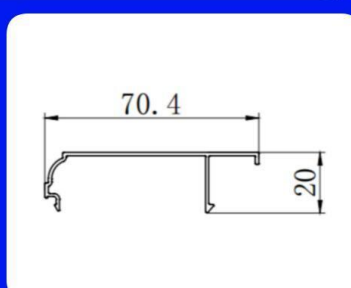
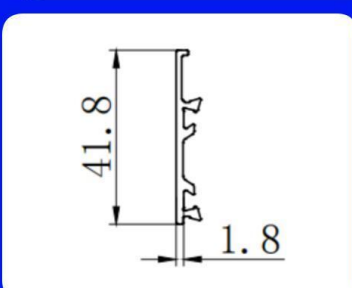
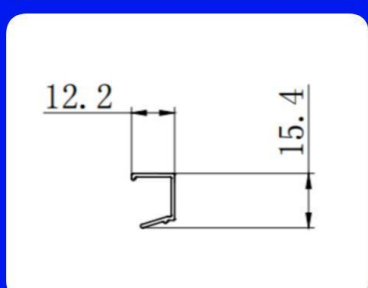
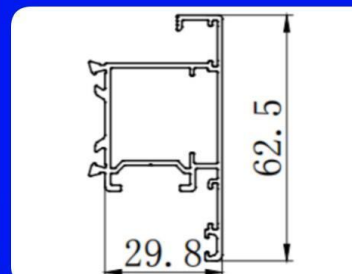
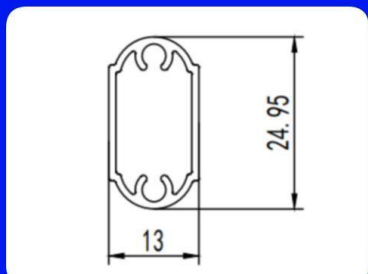
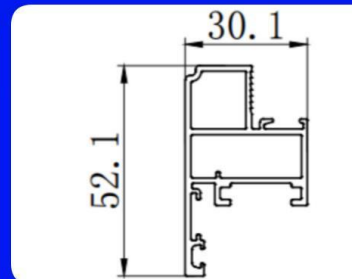
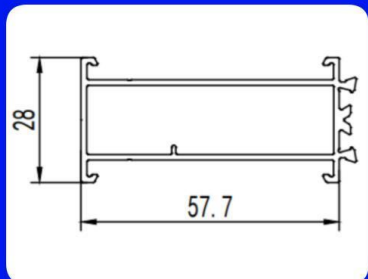
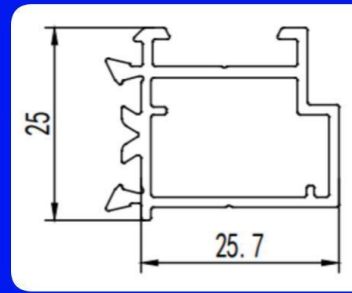
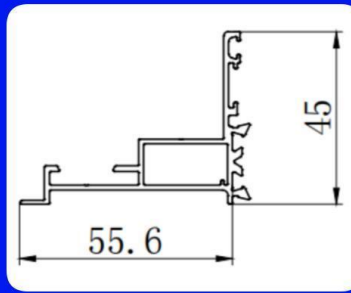
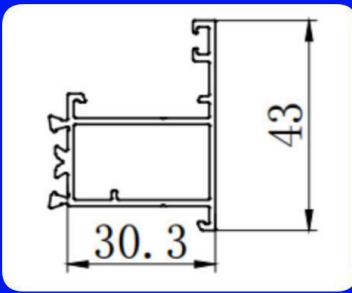
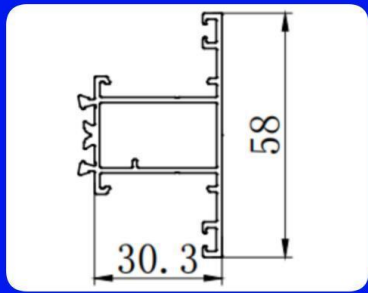

Thermal Break

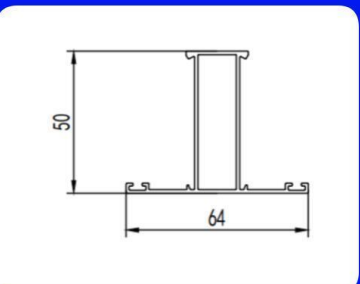
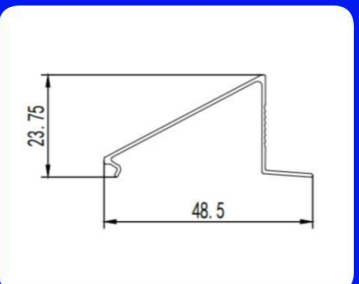
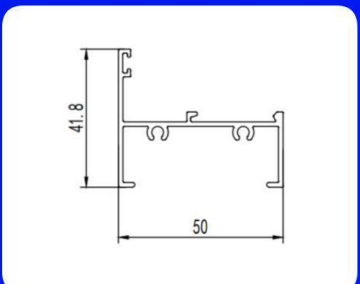
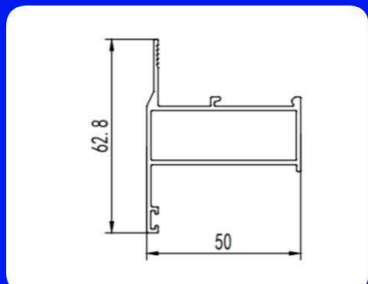
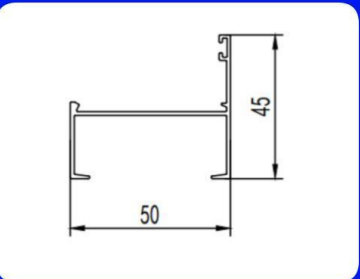
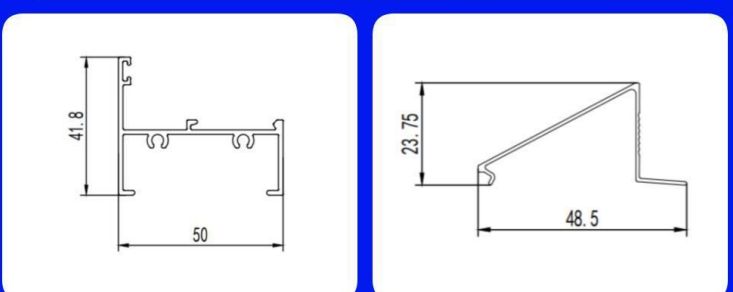
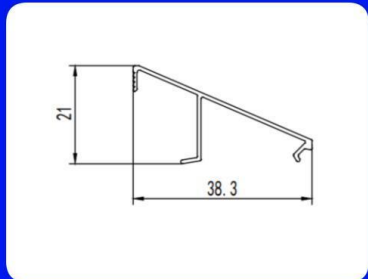
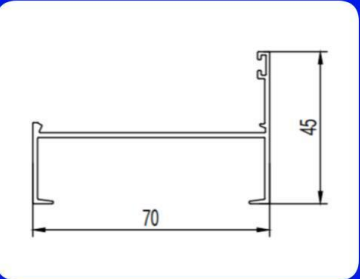
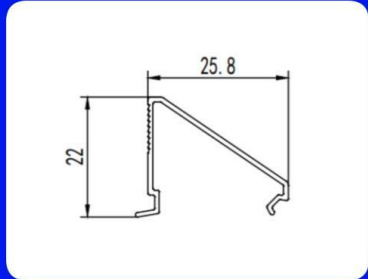
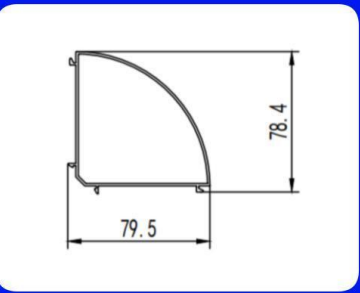
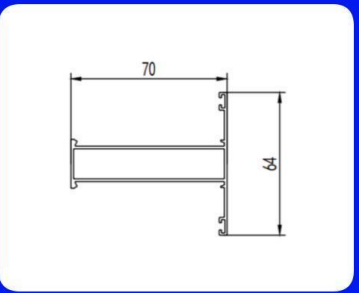
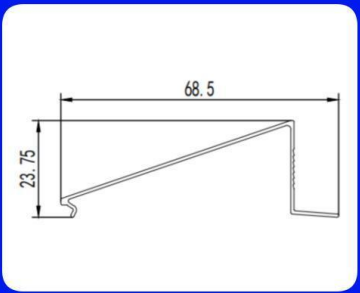
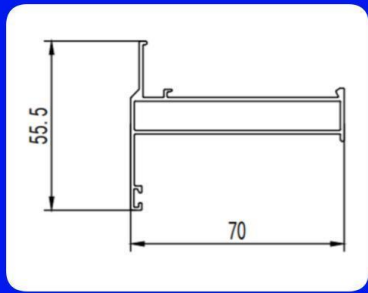

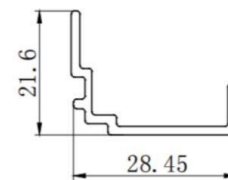
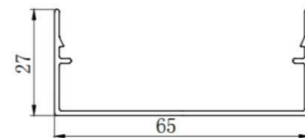
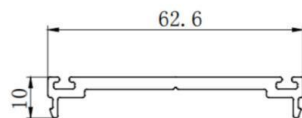
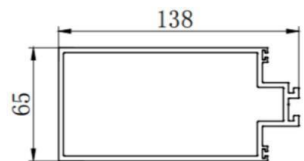
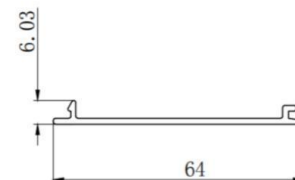
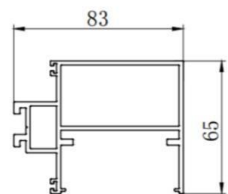
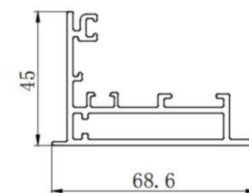
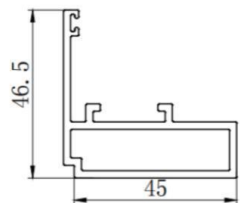
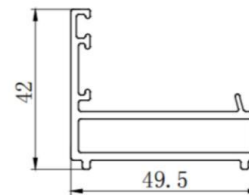
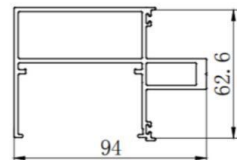
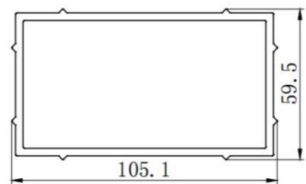
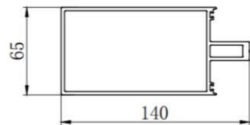

Curtain Wall

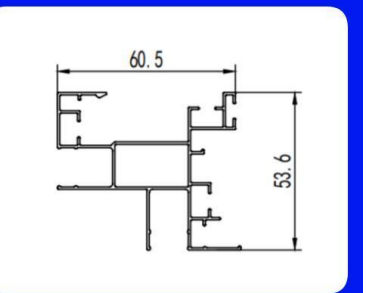
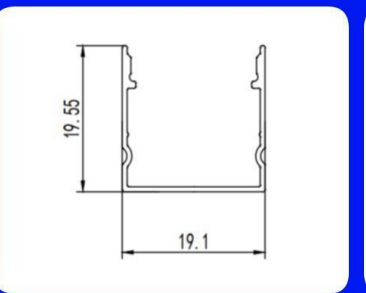
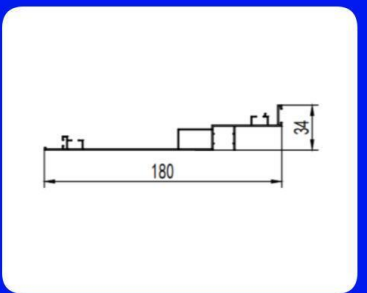
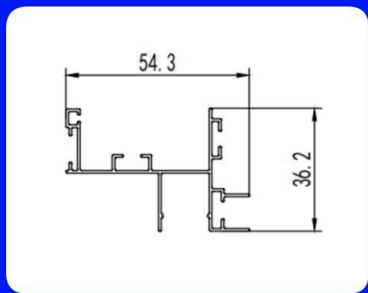
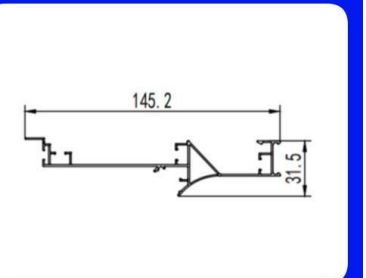
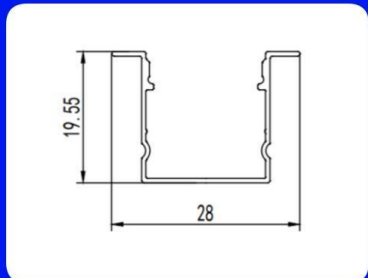
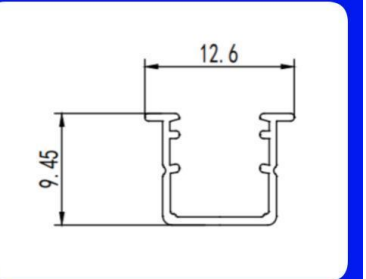
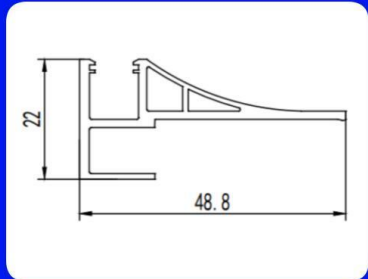
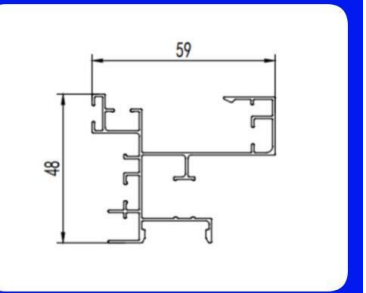
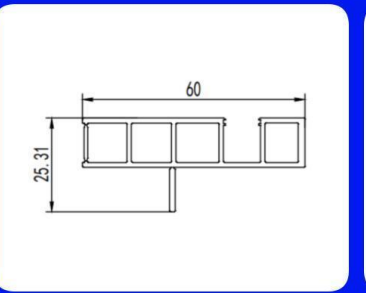
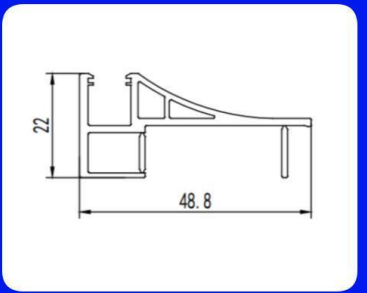
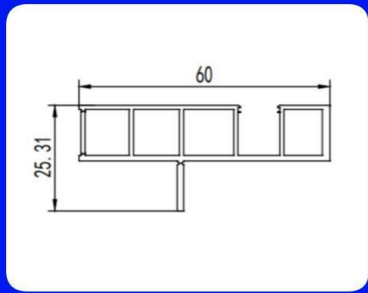

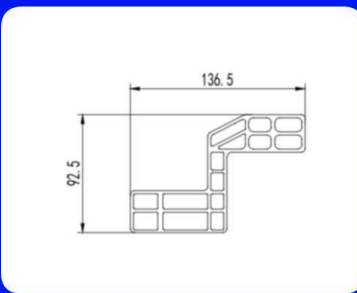
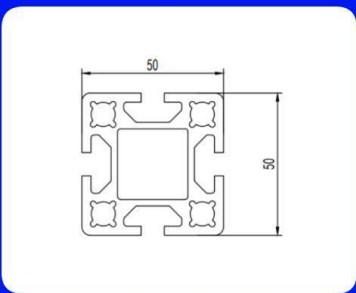
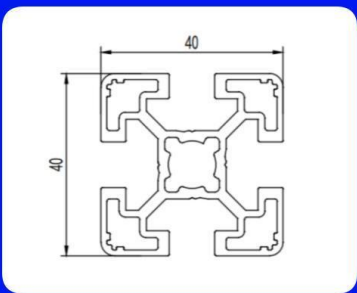
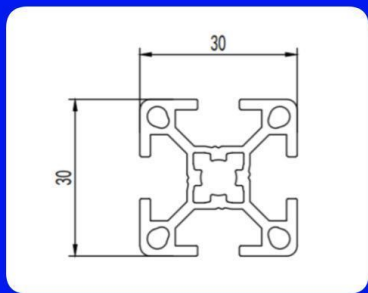
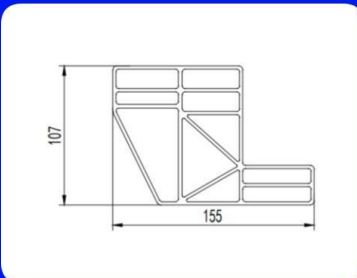
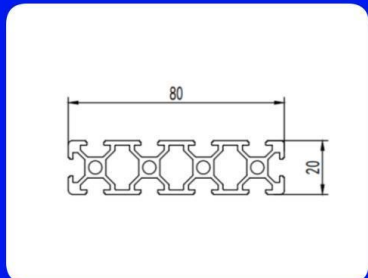
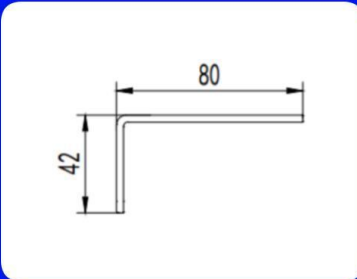
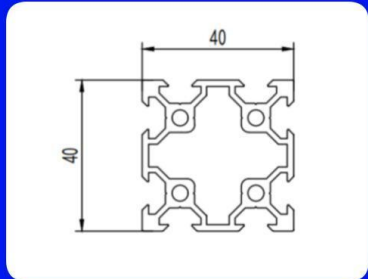
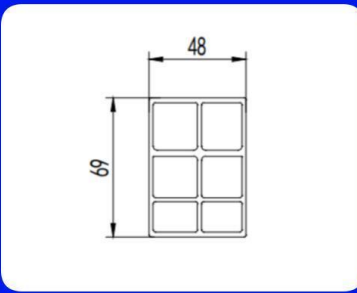
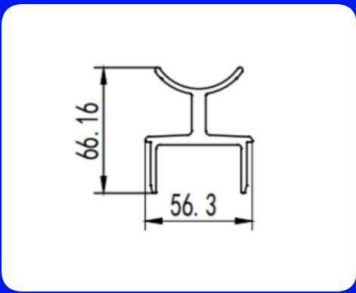
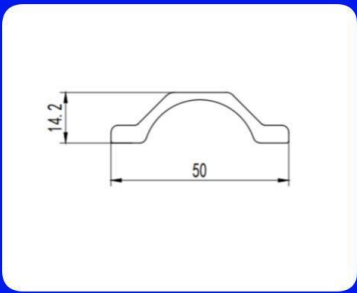
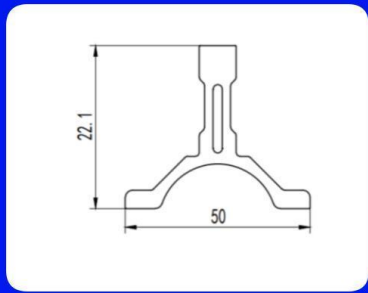

Bracket

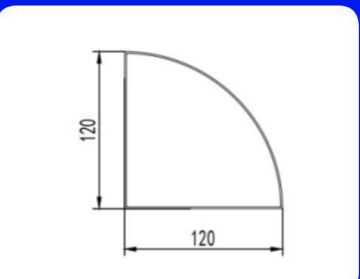
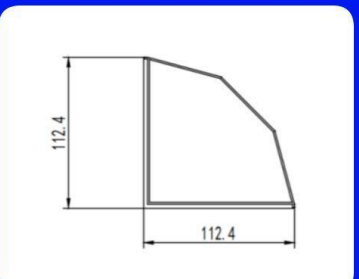
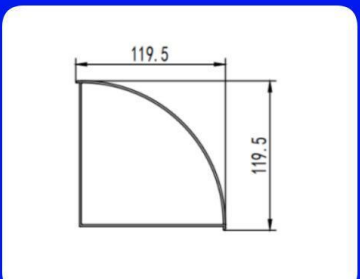
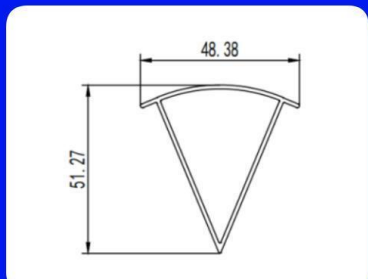
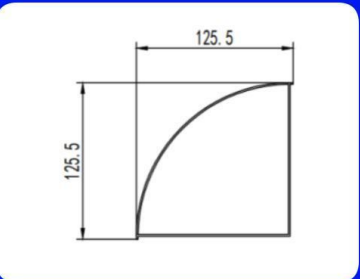
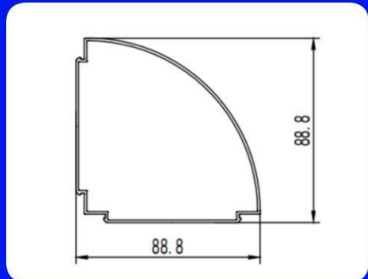
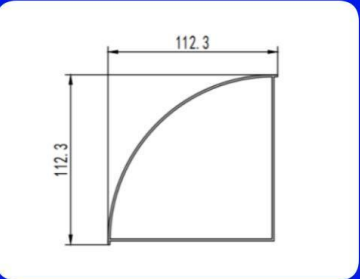
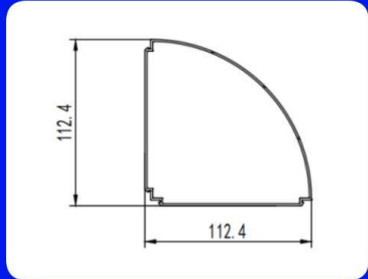
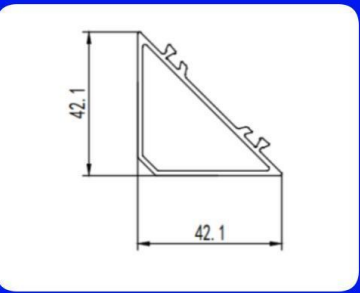
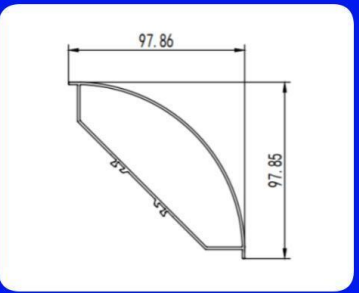
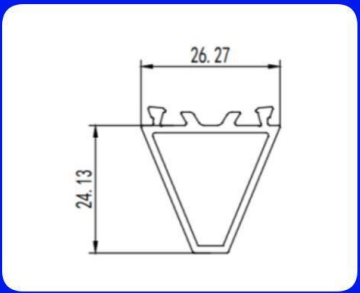
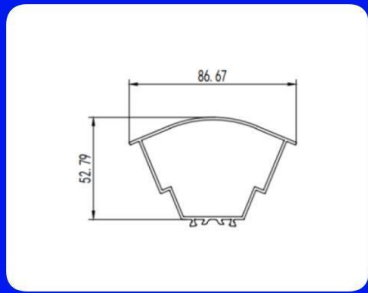

Corner

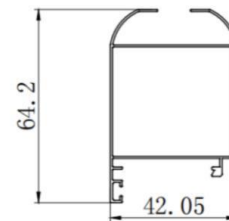
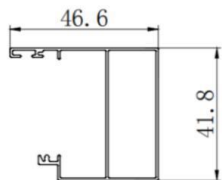
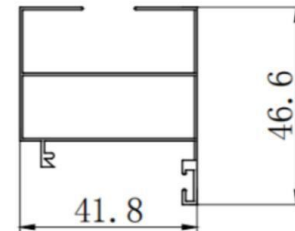
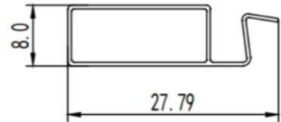
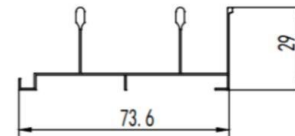
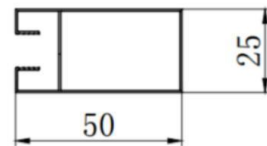
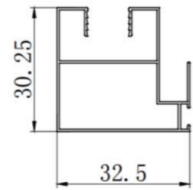
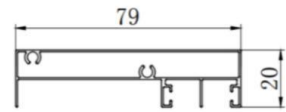

Window & Door

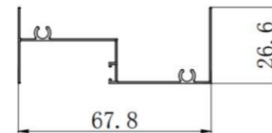
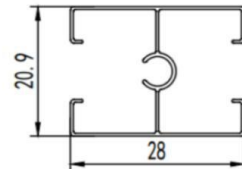
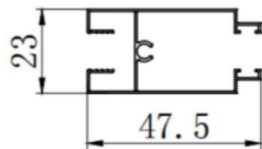
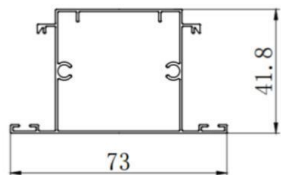

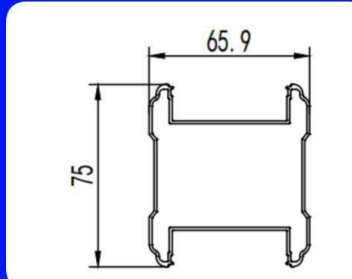
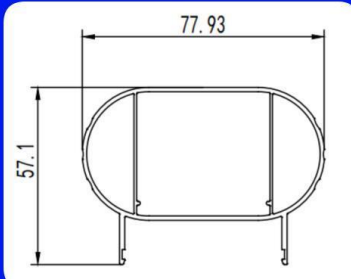
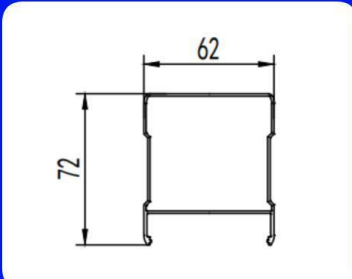
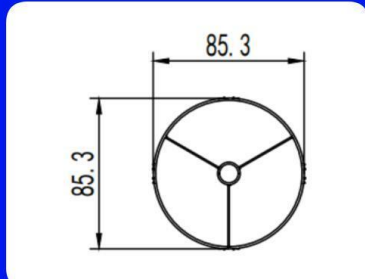
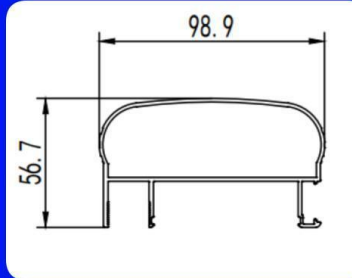
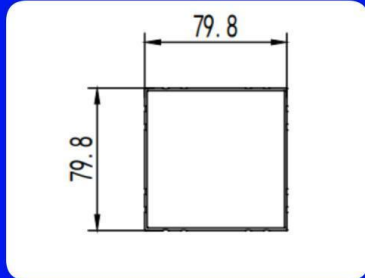
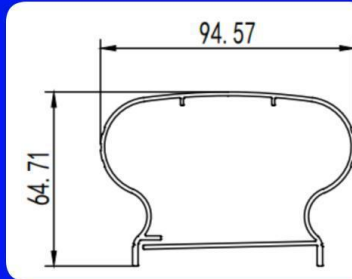
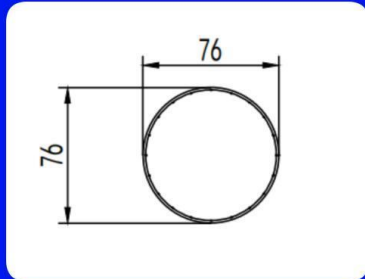
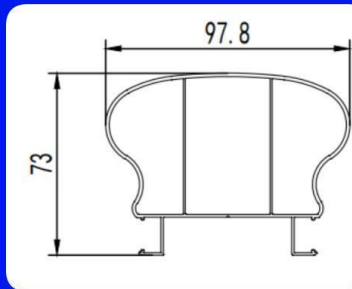
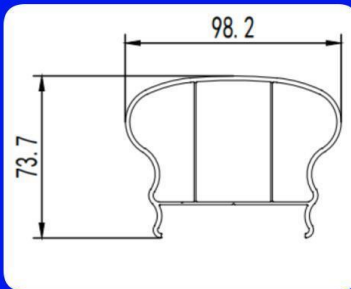
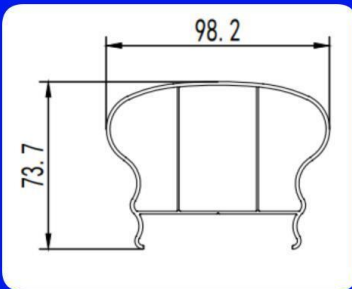
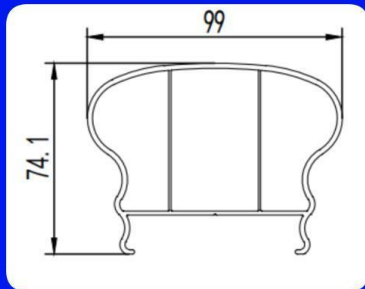

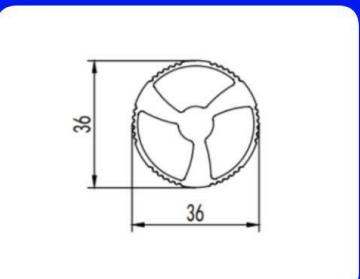
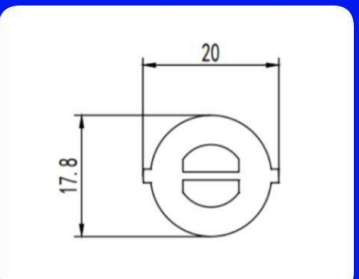
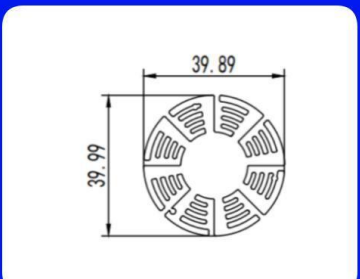
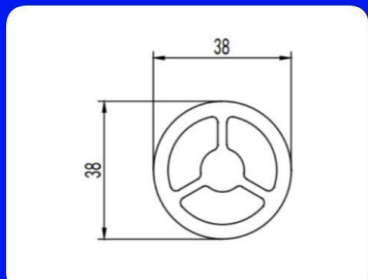
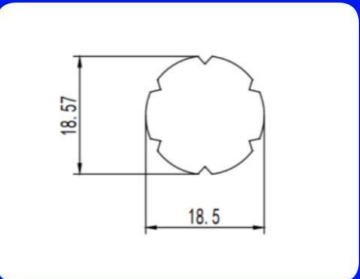
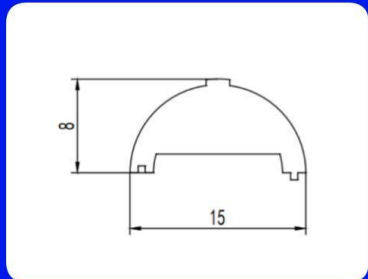
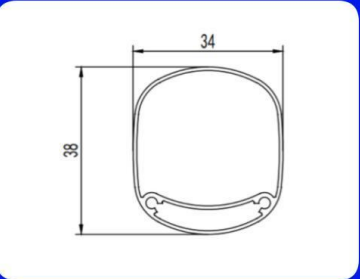
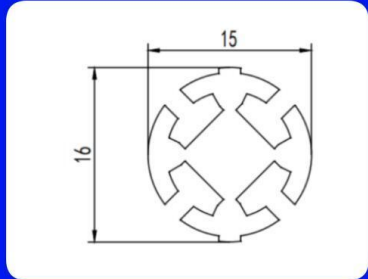
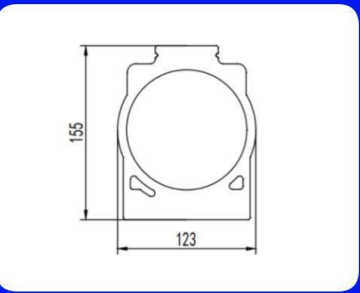
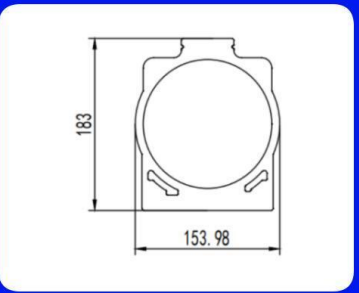
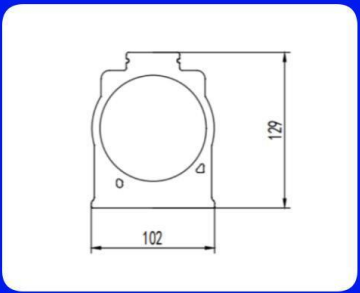
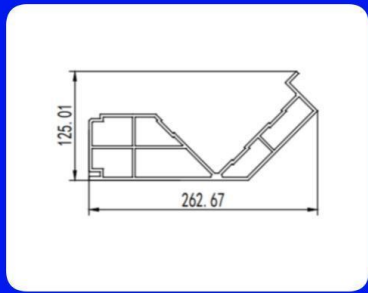

Industrial Material

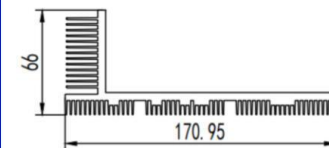
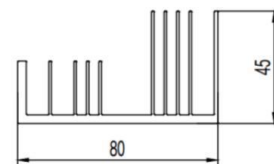
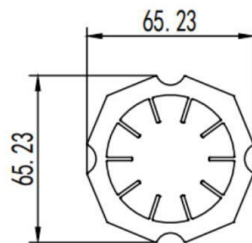
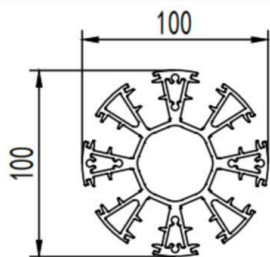
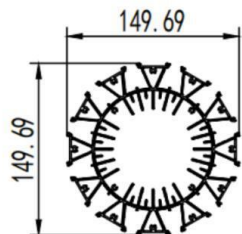
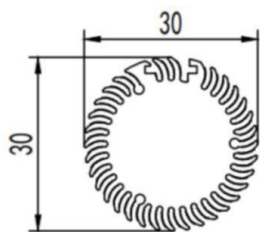
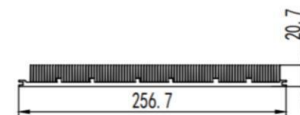
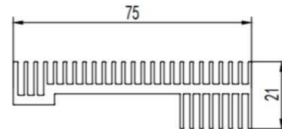
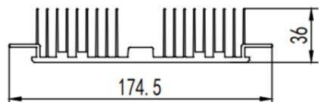
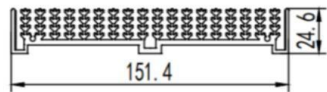

Radiator

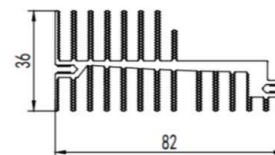
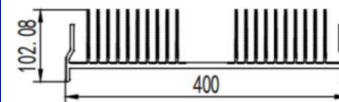

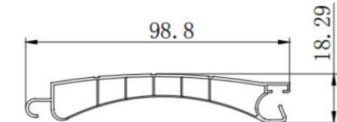
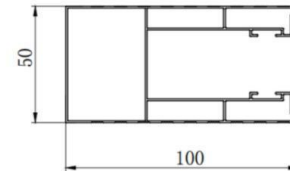
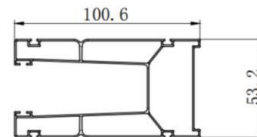
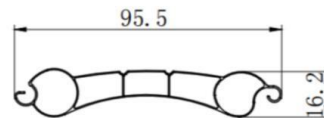
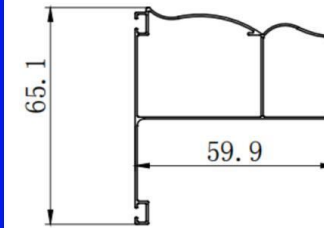
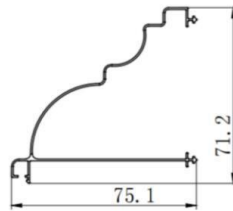
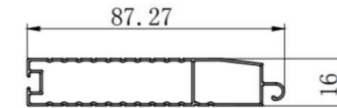
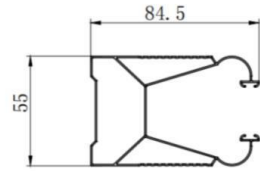
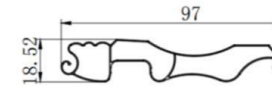
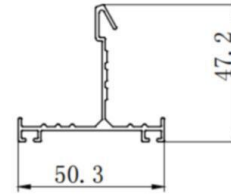
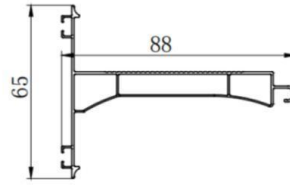
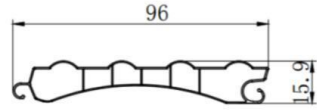

Rolling Shutter

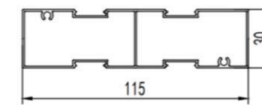
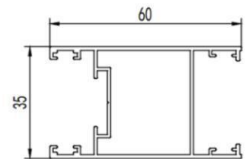
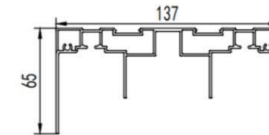
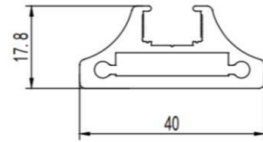
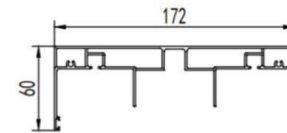
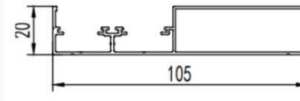
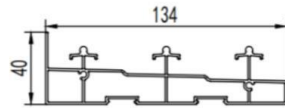
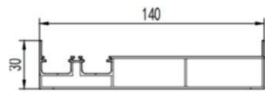

Sanitary

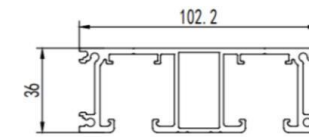
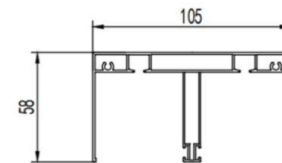
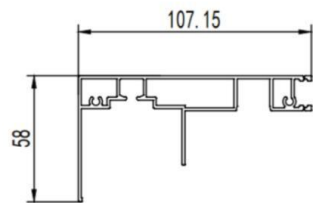
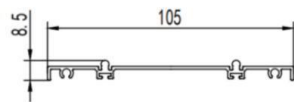

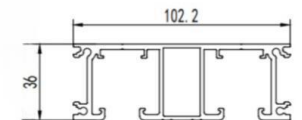
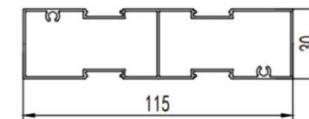
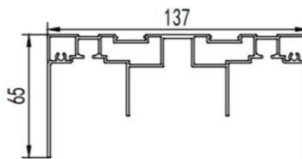
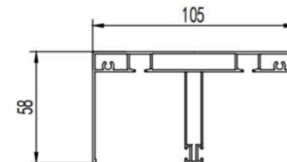
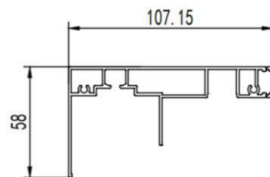
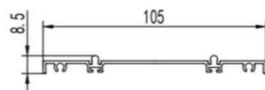
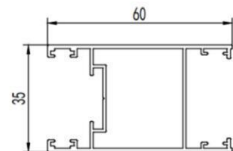
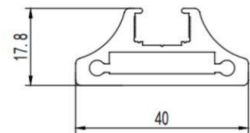
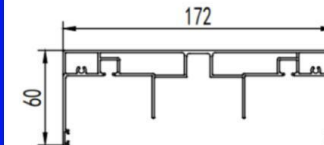
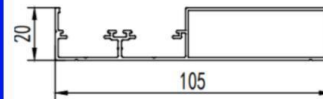
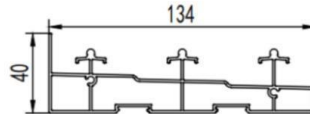
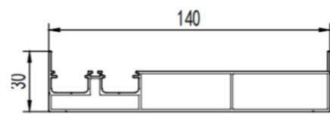

Sliding Door



Photovolatic

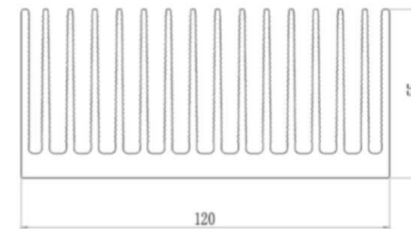
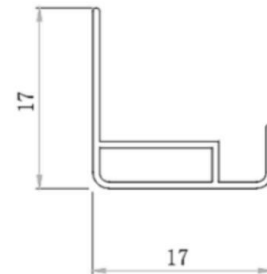
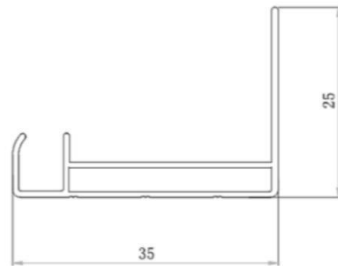
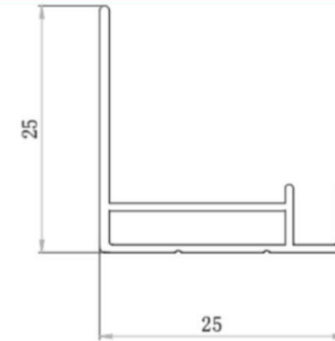
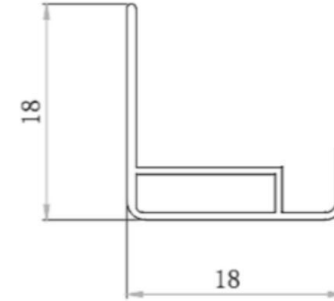



Furniture

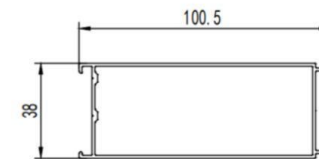
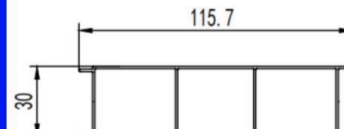
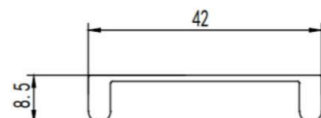
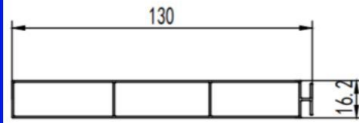
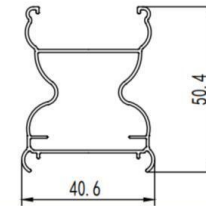
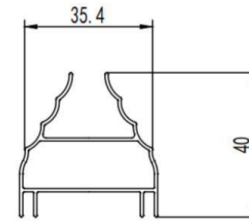



捷力威

佛山市捷力威金属制品有限公司 Foshan Jielawei Metal Products Co., Ltd.

电话(TEL): +86-0757-87380056

手机(Moble): +86-18042861215

邮箱(E-mail): 769303271@qq.com

网址(Website): www.foshanjlw.com

地址(Address): 佛山市三水区三溪创新大道西中心工业园C区16号
No. 16, Area C, West Central Industrial Park, Chuangxin Avenue, Leping Town,
Sanshui District, Foshan City, Guangdong Province

