



NUTECH



STORAGE SOLUTION SPECIALIST

TABLE OF CONTENTS



ABOUT US	01
RACKING COMPONENTS	02
SELECTIVE PALLET RACK	04
DOUBLE DEEP RACK	05
VERY NARROW AISLE RACK	06
MEZZANINE FLOOR	07
MULTI-TIER SHELVING	08
MODULAR SHELVING	10
DRIVE-IN RACK	14
SHUTTLE RACK	16
NUTECH SHUTTLE CAR	18
FLOW RACK	20
LONGSPAN SHELVING	21
STEEL PALLET	22



ABOUT US

Founded in 1990, **Nutech** backs every single product and storage solution with more than 30 years of leadership storage experience.

Serving a broad spectrum of local and international clientele, we export to customers in Australia, Middle East, Indonesia, New Zealand, Philippines, Singapore, Sri Lanka and Vietnam.

Today, we are the leading manufacturer in the region, renowned for top quality products and unmatched customer service. This exceptional expertise enables **Nutech** to deliver storage systems that are engineered for top storage efficiency, unrivalled ease of use and superb product quality.



CUTTING EDGE TECHNOLOGY - OFFERS UNRIVALLED VALUE

With modern CAD-Cam & CNC technology, the production processes are highly automated. Computer controlled on-line precision automated punching, roll forming machine and robotic arms churn out shelving, beams, uprights and other precision components at breath-taking speed allowing Nutech to offer superb products at competitive price.



QUALITY AND DISTINCTION

Our processes adhere to stringent quality control and management system, enable Nutech to offer unrivalled user satisfaction. We deliver innovative storage solutions with the performance to handle very complex logistics requirements.



FINISHING

Nutech components undergo extremely stringent surface treatment to remove dirt, oil and other impurities before being epoxy powder coated.

RACKING COMPONENTS

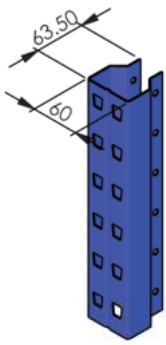

N60 UPRIGHT

FRAME

UPRIGHT	
Model	Load Per Frame
N60	6000 ~ 9500 kg
N90A	8200 ~ 13600 kg
N90B	10000 ~ 17000 kg
N115	16900 ~ 28860 kg

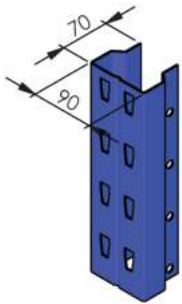

N90A UPRIGHT

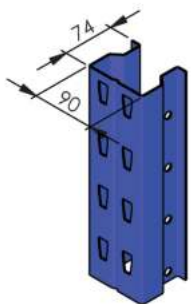

N90B UPRIGHT

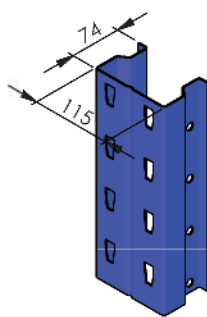

N115 UPRIGHT

PALLET RACKING SYSTEM

1. Frame
2. Beam
- 3a. Standard Base Plate
- 3b. Heavy Duty Base Plate
4. Levelling Plate
5. Row Spacer
6. Pallet Support Bar / Shelf Support
7. Drum Support
8. Pallet Foot Support
9. Safety Mesh
10. Upright Protector
11. Frame Protector
12. Wooden or Metal Shelving
13. Fork Spacer
14. Sectional Shelf
15. Splice Plate

BEAM

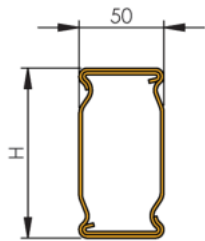

SC BEAM	
Model	Height H (mm)
SC75	75
SC85	85
SC100	100
SC120	120
SC140	140

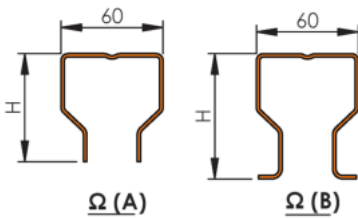

OMEGA BEAM	
Model	Height H (mm)
ΩA	63.5
ΩB	73.5

Height (mm)	Depth (mm)	Bay Width (mm)
2000	600	1500
3000	900	1850
3450	1000	2450
4500	1100	2700
6000	1200	3000
7500	1500	3300
9000		4000
12000		

a > 75mm. b > 75mm. c > 100mm
h = first beam level.

BASE PLATE

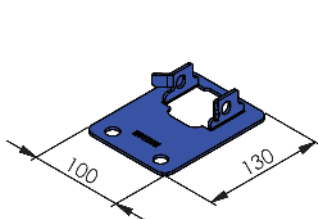

Standard Base Plate

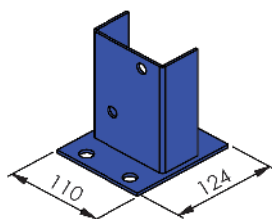

Heavy Duty Base Plate

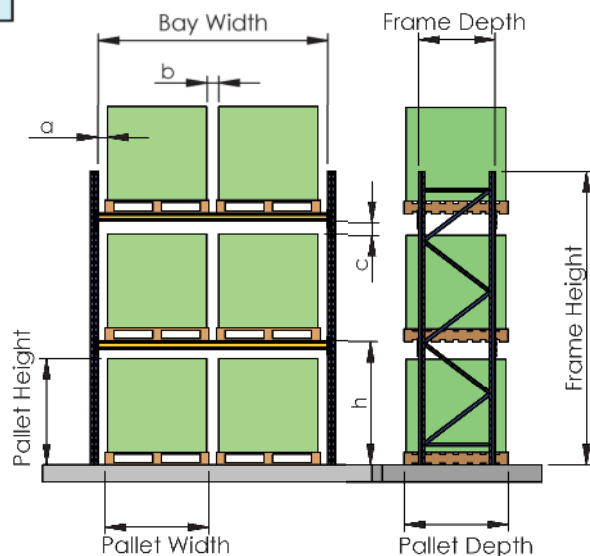

We offer a wide range of safety features and accessories to protect pallet load and personnel against fire, fork truck error and accidental damage.

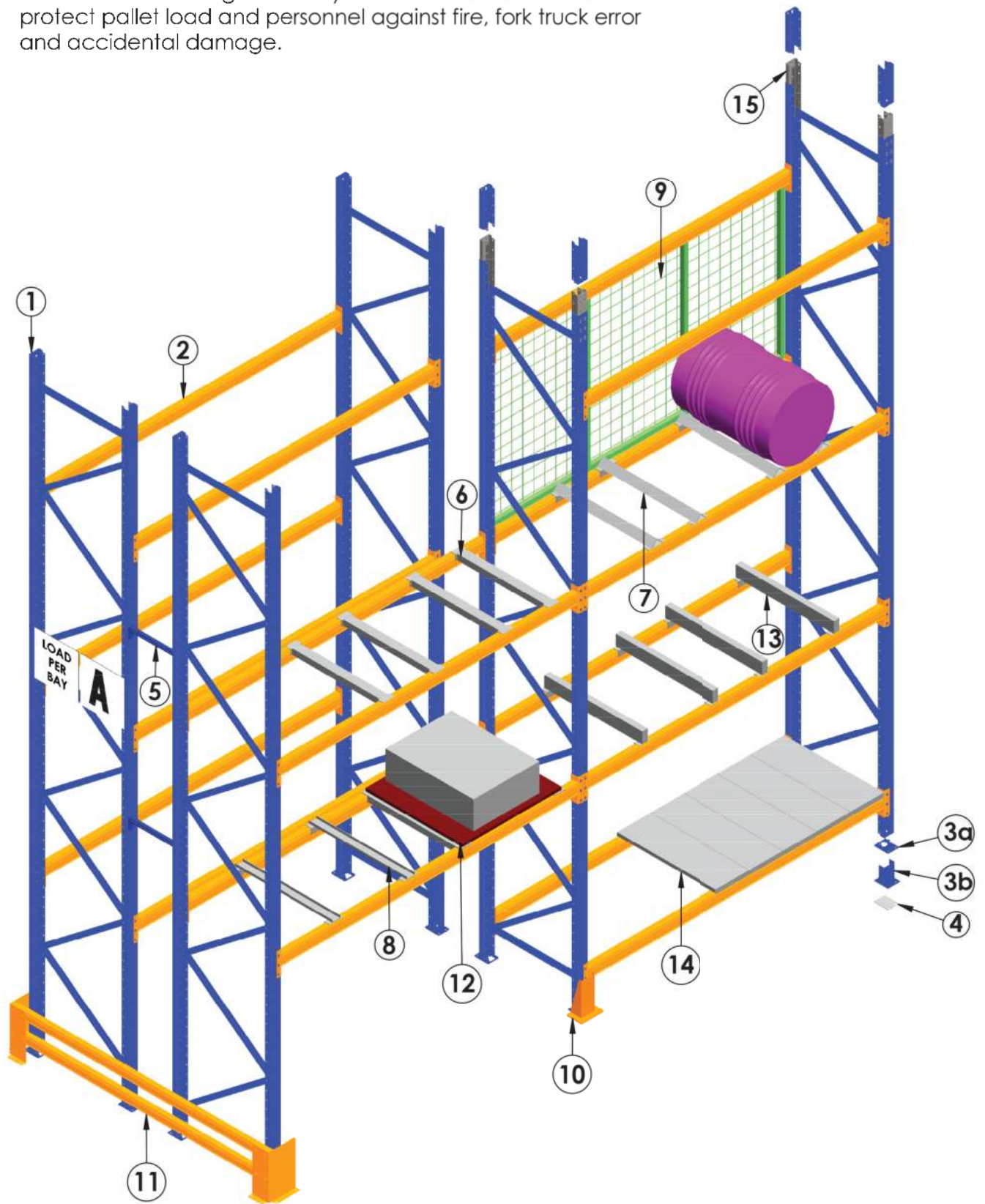

All rack supplied are covered by one year extensive warranty against defect in manufacture. Consult us before any adjustment is done. Due to continue product development, **NUTECH** reserves the right to amend specification details without prior notice.

SELECTIVE PALLET RACK

In any warehouse, one of the most valuable assets is space. This is the most economical and versatile racking system in the industry. It can be customized to suit various storage needs of any type of warehouse environment.

Features:

- ✓ Efficient use of **warehouse space**.
- ✓ **Immediate access** to every pallet stored.
- ✓ **First-In/First-Out (FIFO)** operation.
- ✓ Suitable for **various** types of **material handling equipments**.
- ✓ **Adjustable beam levels** to accommodate new pallet sizes.
- ✓ **Minimal labor** for installation and dismantle of rack.



DOUBLE DEEP RACK

Double deep pallet racking offers higher storage density than selective pallet racking where instant accessibility to the rear pallet is not required. A special fork truck is required to access the rear pallet.

Features:

- ✓ **Increase storage** density by about 30-40% compared to selective pallet rack.
- ✓ **Convertible** to and from selective racking system.
- ✓ **First-In/Last-Out (FILO)** operation.
- ✓ Suitable for operation that requires **less critical picking and storing** speed.
- ✓ Easily **reconfigured** by adjusting **beam height**.



VERY NARROW AISLE RACK

A narrow aisle pallet racking system uses a similar basic layout that a standard pallet racking system does, but with narrower aisles between each pallet. It is ideal for a business that requires a high degree of flexibility and access to stock at all times and yet floor space is limited.

Narrow-aisle racking is space efficient in two ways:

- **Less floor space** for the aisles, thus freeing up more space for storage.
- Pallets can be **stacked** to a greater height, thereby further increases available storage capacity.

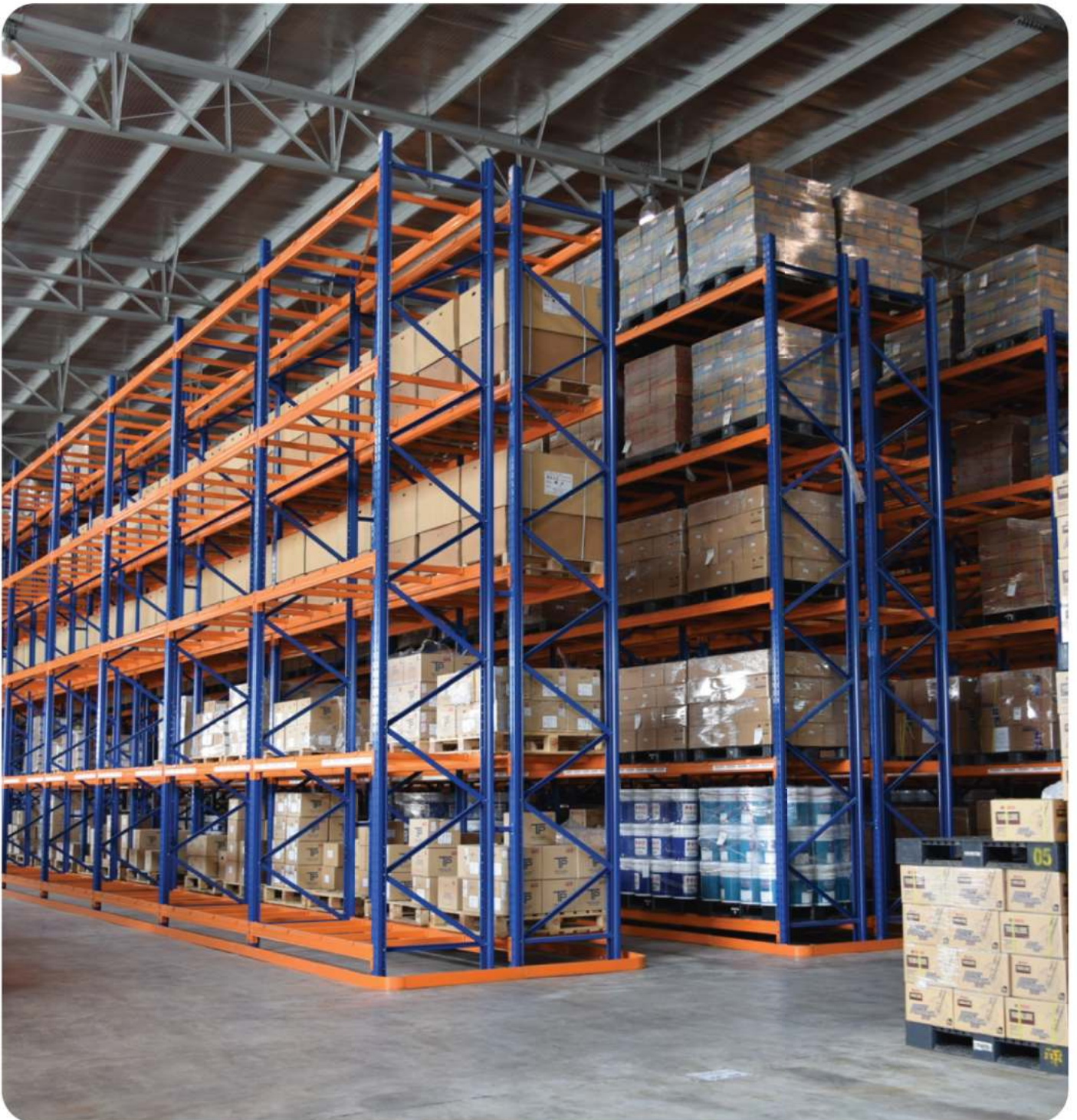

MEZZANINE FLOOR

Mezzanine system allows you to change empty overhead space into usable storage areas. Depending on the size of your facility, a mezzanine can be one, two or more levels high. Nutech mezzanine system is totally disassembled and can be easily relocated to another facility if your storage requirement changes.

Enclosed with hand and knee rails, it creates a secure space for storage and picking tasks. Pallet gate can be installed for safety buffer for loading and unloading from the ground level. Sturdy and adaptable to different heights, staircase designed by Nutech is easy to install and provide quick access to mezzanine floors.

Features:

- ✓ **Maximize** floor space usage.
- ✓ Convert **overhead space** to become usable storage space.
- ✓ **Quick** and **simple** assembly.
- ✓ Suitable to store **hand pick** storage goods.
- ✓ **Custom designed** to suit your particular needs.
- ✓ **Flooring** material: Steel plate / plywood / cement board.



Steel Mezzanine with Staircase & Handrails



Rack Supported Platform

MULTI-TIER SHELVING

Nutech multi-tier shelving system provides storage space at multiple levels, thus optimizes the vertical storage space available in a warehouse. Each floor level can be accessed by staircase and are linked by walkways. The design options of multi-tier systems are virtually unlimited.

Features:

- ✓ **Optimizes vertical storage space**, increasing storage capacity by a significant percentage.
- ✓ **Systematic arrangement** greatly enhances efficiency during order picking, stock replenishment and stock checking.
- ✓ **Ideal for handpicked items** such as spare parts, carton box or documents.
- ✓ **Removes need for bulky handling equipment** such as forklifts, and the need to install a permanent mezzanine floor.



MULTI-TIER SHELVING



Multi-tier Longspan Shelving with Wiremesh Fencing



Staircase for easy access to the upper tier

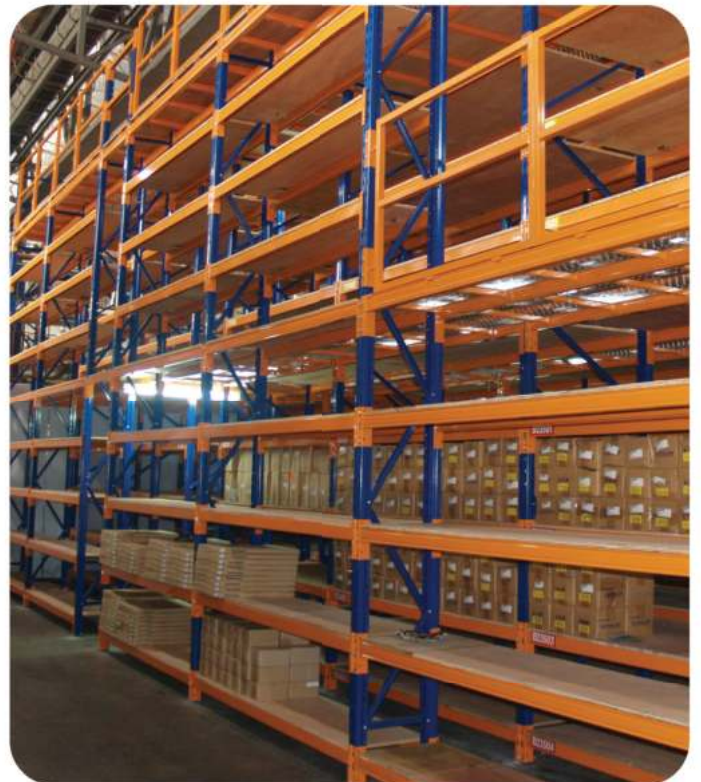

Longspan Rack Supported Platform

MODULAR SHELVING

N60 Modular multi-tier and shelving is a versatile, flexible and high-density storage system. It is specifically designed to store large quantity of **high value small parts**.

It is Ideal for **pharmaceuticals, automotive, machinery, electronics, jewelry, aerospace, biotechnology** and a host of other industries that systematic storage of **small parts** is crucial.



Nutech Modular Racking System with Staircase & Handrails



Galvanized Modular Shelving



Steel Plank Flooring



Semi-Open Plastic Bin

MODULAR SHELVING

N60 Modular Shelving is offered in a combination of sizes.

Shelf Depth (mm)	Shelf Width (mm)	Shelf Capacity (kg)	Rack Height (mm)
400	900	120	1,800
500	1050	160	2,400
600	1225	300	3,000
			3,600
			4,000
			4,500
			6,000



MODULAR SHELVING

Features:

Rust & Dust Free



Manufactured from high quality zinc coated steel sheet, galvanized shelf remains clean and shining years in and years out.

Trolley Friendly



Its smooth surface allows trolley with castor wheel of any size and type to be used on it. The surface can be cleaned easily.

Enhanced Safety Level



Exposed sides of mezzanine floor are protected by securely fixed kick plate, knee rail and hand rail to ensure safety of the workers.



MODULAR SHELVING

Accessories

Back Mesh Fencing



Back mesh fencing prevents **unauthorized access** to certain area or acts as a back stopper for goods **separation** purpose.

Industrial Grade Staircase



Nutech's staircase provides **secure, safe** and easy **access** between two levels and makes full use of the **space** available.

Pallet Gate



Nutech's swing-type pallet gate allows safe and **efficient** loading and unloading of palletized goods.

Steel Door



Steel door can be fitted for storing high value components. Nutech's steel door features **tamper-proof design**.

DRIVE-IN RACK

Drive-in rack is a cost effective, high-density pallet storage system designed to maximize the warehouse space available by minimizing the operating aisles needed for trucks.

Loading and unloading are undertaken by means of counterbalance truck or reach-trucks that drives down each lane into the racks.

Features:

- ✓ Increased storage space.
- ✓ Space utilization about 75~80% of floor space.
- ✓ Ideal for **fast moving** products or products with a **long shelf life**.
- ✓ **Cost-effective** storage strategy.

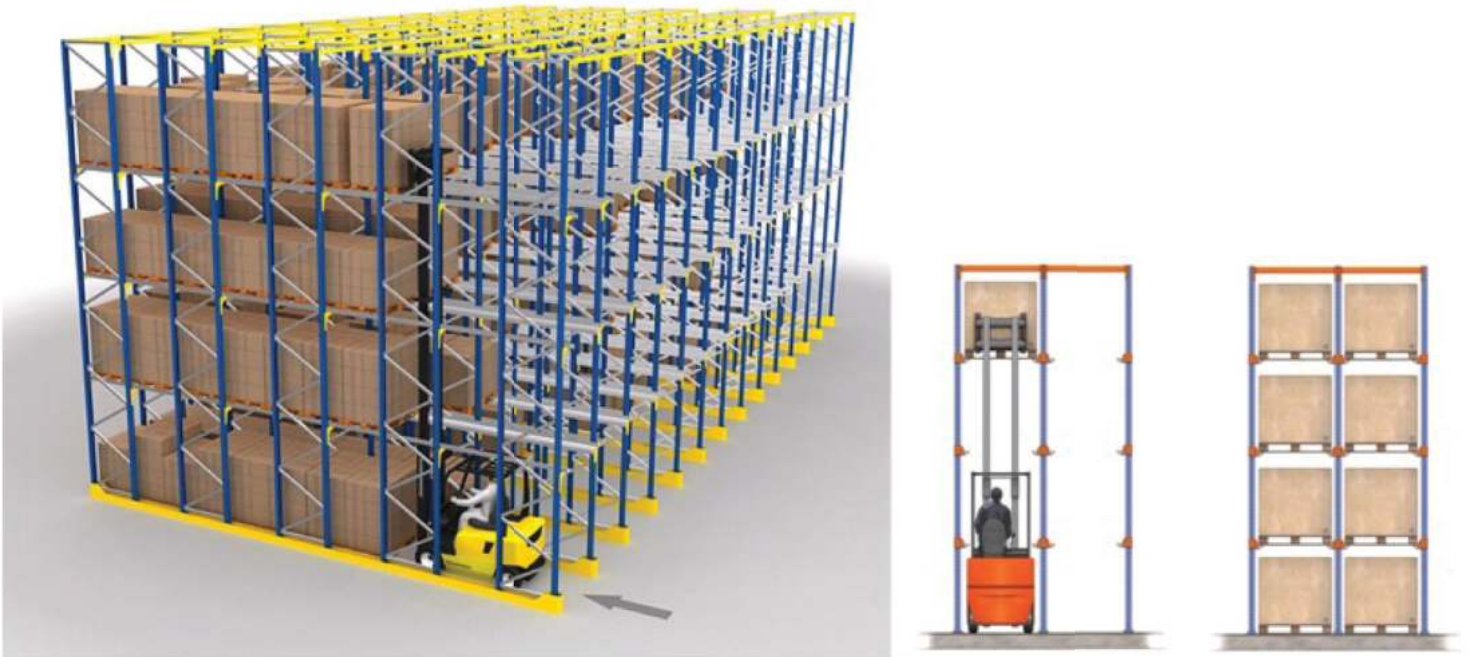

Pallets are loaded and retrieved from the same side, creating **First-In/Last-Out (FILO)** access.

DRIVE-IN RACK



Nutech's Drive-In Rack



7 Pallets Deep Drive-In Rack with Rails

SHUTTLE RACK

A semi-automated, high-density storage solution using self-powered shuttle car operating independently to transfer pallets into the rack. Cost-effective and time-saving, it replaces the need for forklift trucks to enter the aisles.

Features:

- ✓ **Maximize floor space and height** by minimizing the operating aisles.
- ✓ **Automatic control** of inventory by using sensors to count the number of pallets stored.
- ✓ **Reduces risk** to operators and potential **damage** of equipment and inventory.
- ✓ **Flexible storage** for different types of pallets.

Shuttle Rack Models

FIRST IN FIRST OUT (FIFO)



First-In First-Out (FIFO) control is secured by storing from the front of the Shuttle Rack and retrieving from the opposite side. FIFO model is ideal for storage of perishable goods so that the goods that were stored first are also the first to be removed.

FIRST IN LAST OUT (FILO)



First-In Last-Out (FILO) control is a one-sided storage and retrieval of goods whereby the goods stored first are the last to be removed. FILO model allows the most compact type of storage in a channel storage system.

SHUTTLE RACK



Pallet Rail (Galvanized)

NUTECH SHUTTLE CAR

How It Works



1. Shuttle Car is placed into the entrance of the required rack lane using a forklift.



2. Pallets to be loaded are picked up by forklift and placed on the Shuttle Car.

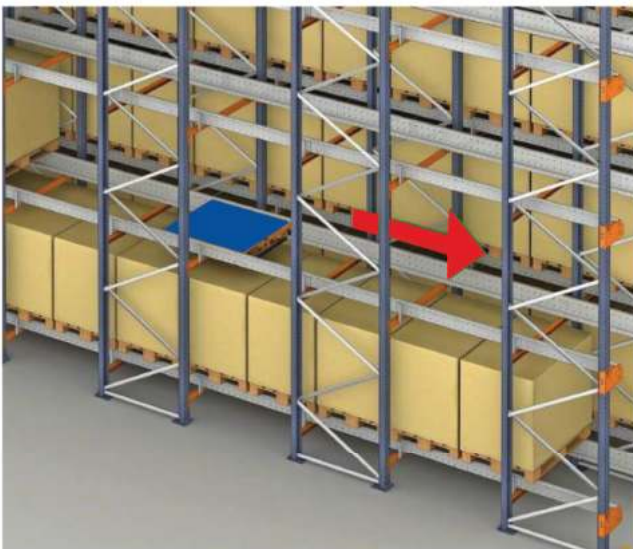

4. Once the pallet is stored, Shuttle Car returns to the entrance (home position) to repeat the process or execute a new command.

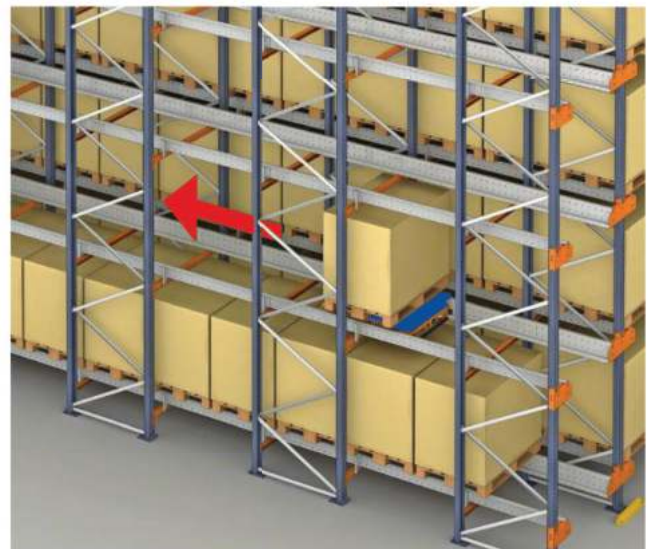

3. Movement commands are transmitted to the Shuttle Car via a wireless handheld remote control. Shuttle Car lifts the pallet and transfers it to the nearest storage space available.

NUTECH SHUTTLE CAR

Standard Shuttle Sizes

No.	Pallet Width (mm)	Pallet Depth (mm)	Max. Pallet Weight (kg)
1	1,200	1,000	1,500
2	1,200	1,200	1,500
3	1,000	1,200	1,500

Applications

- Fresh Fruit Importer and Distributor
- Chemical Industry
- Food Industry
- Animal Feed
- Edible Oil Industry
- Lubricant Industry

Unique Functions of Nutech Shuttle Car

- **Automatic Deposit Process**
Every time a pallet is placed at the entrance of the rail, the shuttle car will automatically moves the pallet into the first available space within the rail.
- **Automatic Retrieval Process**
The shuttle is deployed by placing it on the rail at the exit. Upon pressing the retrieve button, the shuttle will automatically move into the rack to retrieve the first available pallet to the exit.
- **Automatic Re-arrangement of Pallets**
For FIFO operation, the shuttle re-arranges deposited pallets to reduce travel time from pallets to the exit, thereby shortening retrieval time.
- **Automatic Pallet Count**
Nutech shuttle car is able to count quantity of pallets stored on a particular track automatically, thus eliminating the need to manually count pallet quantity. Scanned pallet quantity will be displayed on the remote handheld device.



Nutech Shuttle Car



Battery Charging Trolley



Remote Control

FLOW RACK

A storage system that relies on gravity flow to load, organize and retrieve stored cartons or pallets within a warehouse.

Goods are loaded into the high end of the rack, one by one. Within a confined lane, the goods then travels forward over a deck of rollers, filling the structure from front to back end. Each flow lane includes self-energized speed controllers (brakes) to gently control the speed of movement within the flow lanes.

Features:

- ✓ Saves time, space and labor
- ✓ Provides high density storage
- ✓ Cost Efficient
- ✓ Shelves can be adjusted to meet product dimensions
- ✓ Reduces loading and unloading congestion

Applications

- Food & Beverage Industry
- Automotive Supplies



Pallet Stopper & Gravity Roller



LONGSPAN SHELVING

Designed for wide span goods which are deposited and retrieved manually from shelves. Its modular design allows you to add more shelves or bays as your business grows. Each level is clad with plywood or metal shelving.

Longspan Shelving is offered in a combination of sizes.

Depth (mm)	Width (mm)	Height (mm)
450	1200	1,800
600	1500	2,400
900	1850	3,000
1200	2450	3,500
	2700	4,000
		4,500



Longspan Shelving with G.I Decking



Longspan Shelving with Plywood Decking

STEEL PALLET

Why Choose Nutech Steel Pallet

Steel Pallet	VS	Wooden Pallet
<ul style="list-style-type: none"> Hygienic Fire Resistant Insect Free Recyclable Durable Corrosion Resistant Repairable Splinters Free Cost Effective 		<ul style="list-style-type: none"> Termite Attack Splinters & Nails Flammable Non Eco-Friendly Susceptible to Weather

Features Comparison

Features	Steel Pallet	Plastic Pallet	Wooden Pallet
Strength	★★★★★	★★★★	★★
Durability	★★★★★	★★★★	★★
Fire Resistant	★★★★★	★	★
Moisture Resistant	★★★★★	★★★★★	★
Life Cycle	★★★★★	★★★★	★
Customized	★★★★★	★	★★★★★
Recyclable	★★★★★	★★	★★★★
Scrap Value	★★★★	★	★
Extreme Temperatures	★★★★★	★	★★

Note: Rating scale from 1 to 5 (Poor to Excellent)

STEEL PALLET



2-Way Standard Deck



4-Way Standard Deck



2-Way Full Deck



4-Way Full Deck



2-Way Standard Deck with Top Cover

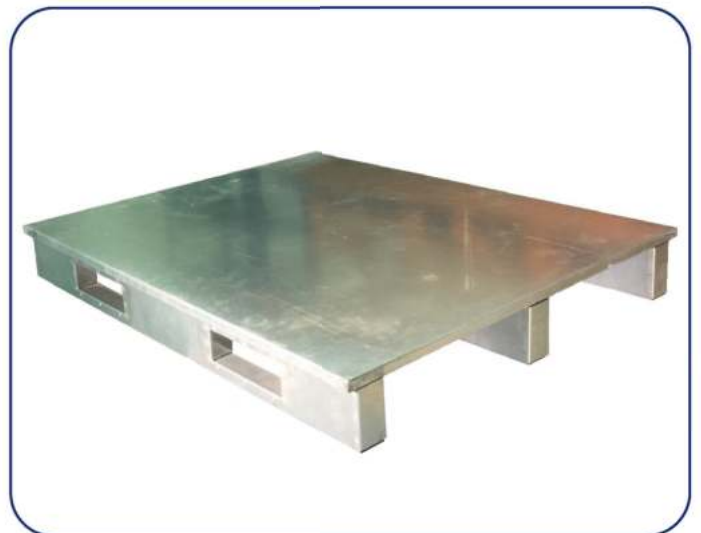

4-Way Standard Deck with Top Cover

2-WAY STEEL PALLET



Features:

- ✓ 2 way fork entry
- ✓ Light to medium duty application
- ✓ Natural zinc finish
- ✓ Customize size available
- ✓ Optional steel cover for goods in sacks
- ✓ Ideal replacement for wooden pallet

2 WA Series – Non-return Export Pallet

No.	Model No.	Dimension				Uniformly Distributed Load Capacity (kg)		
		Depth	Width	Height (H)	h	Static	Dynamic	Selective Rack
1	2WA1111	1100	1100	112	90	1000	750	500
2	2WA1208	1200	800	112	90			
3	2WA1210	1200	1000	112	90			
4	2WA1310	1300	1000	112	90			
5	2WA1311	1300	1100	112	90			

2 WB Series – Medium Duty Pallet

No.	Model No.	Dimension				Uniformly Distributed Load Capacity (kg)		
		Depth	Width	Height (H)	h	Static	Dynamic	Selective Rack
1	2WB1111	1100	1100	112	90	1000	750	500
2	2WB1208	1200	800	112	90			
3	2WB1210	1200	1000	112	90			
4	2WB1310	1300	1000	112	90			
5	2WB1311	1300	1100	112	90			

4-WAY STEEL PALLET

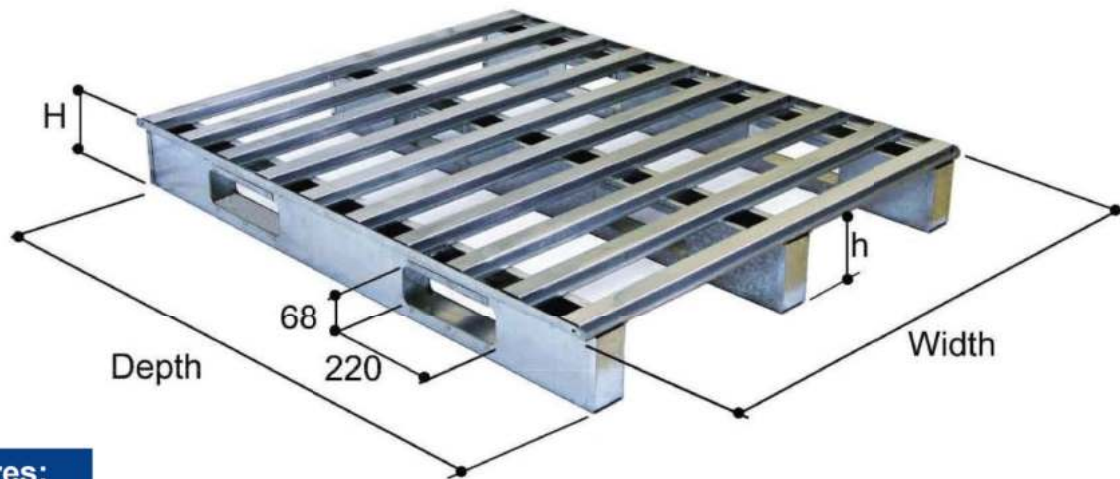

Features:

- ✓ 4 way fork entry
- ✓ Heavy duty application
- ✓ Natural zinc finish
- ✓ Customize size available
- ✓ Optional steel cover for goods in sacks
- ✓ Ideal replacement for plastic pallet

4 WA Series – Heavy Duty Pallet

No.	Model No.	Dimension				Uniformly Distributed Load Capacity (kg)			
		Depth	Width	Height (H)	h	Static	Dynamic	Selective Rack	Drive-in Rack
1	4WA1111	1100	1100	142	120	3000	1800	1800	1800
2	4WA1208	1200	800	142	120				
3	4WA1210	1200	1000	142	120				
4	4WA1212	1200	1200	142	120				
5	4WA1313	1300	1300	142	120				
6	4WA1410	1400	1000	142	120				
7	4WA1412	1400	1200	142	120				

4 WB Series – Heavy Duty Pallet

No.	Model No.	Dimension				Uniformly Distributed Load Capacity (kg)			
		Depth	Width	Height (H)	h	Static	Dynamic	Selective Rack	Drive-in Rack
1	4WB1111	1100	1100	142	120	4000	2000	2000	2000
2	4WB1208	1200	800	142	120				
3	4WB1210	1200	1000	142	120				
4	4WB1212	1200	1200	142	120				
5	4WB1313	1300	1300	142	120				
6	4WB1410	1400	1000	142	120				
7	4WB1412	1400	1200	142	120				

MALAYSIA HQ & FACTORY:

NUTECH MACHINE DESIGN & ENGINEERING SDN. BHD. (194858-K)
NUTECH INDUSTRIES SDN. BHD. (239718-U)

No.8, Jalan Anggerik Mokara 31/44, Section 31, Kota Kemuning,
40460 Shah Alam, Selangor Darul Ehsan, West Malaysia

-  +603 5121 8266
-  +6012 218 9110
-  +603 5121 0266
-  nutech1@nutechmalaysia.com
-  www.nutechmalaysia.com

INDONESIA OFFICE & WAREHOUSE:

PT. NUTECH INDUSTRIES INDONESIA
PT. NUTECH STORAGE SOLUSINDO

Jl. Trembesi Blok F-6 No. 1A, Delta Silicon 3 Lippo Cikarang,
Cicau Cikarang Pusat Bekasi Jawa Barat - Indonesia

-  +62 (021) 8991 5108, +62 (021) 8991 5109
-  +62 (021) 8991 5157
-  nutech@nutech.co.id, sales@nutech.co.id
-  www.nutech.co.id



nutechmalaysia.com



nutech.co.id



A Member of

