



# THREE SINHA

*Trusted name for over 60 years among Sri Lankans*



## COMPANY PROFILE



*60 Years of  
Unparalleled Excellence*



## **GROUP OF COMPANIES**

**THREE SINHA GLASS & ALUMINIUM (PVT) LTD**

**THREE SINHA INDUSTRIES (PVT) LTD**

**THREE SINHA AGROMAC (PVT) LTD**

**THREE SINHA SOLAR (PVT) LTD**

**IKLO INDUSTRIES (PVT) LTD**



**Manujula Ariyakumara**

Managing Director

448, Nawala Road, Koswatta , Rajagiriya.

**0117 65 65 65** [www.threesinha.lk](http://www.threesinha.lk)



## Our Vision

Three Sinha Group is committed to providing with continuously improved means, strategies and products that will help to improve the net worth in business accomplishments, enhance family security and help to create prosperity to the lives of our patrons, whilst enjoying ourselves in the process.

## Our Mission

Three Sinha Group constantly strives hard to be the most creative and sustainable solution provider in our lines of business. We engage in implementing state of the art technology to manufacture and fabricate our products to the highest quality. Our aim is to focus on our attention to detail and provide our services on time as required by our customers.



## Managing Director

My entrepreneurial journey began under challenging circumstances after the loss of my father, taking on the responsibility of supporting five siblings. With no higher education but unwavering determination, I founded Three Sinha Industries, now a pioneering name in Sri Lanka's garage door industry with a 58-year legacy. Starting with steel gate fabrication, I transitioned into automated garage doors, a pivotal move that established our brand. Founded in 1968, Three Sinha, a household name in Sri Lanka, has an impressive 58-years legacy of partnership with our customers, solving their toughest problems in the construction industry. We are proud of our reputation as a solution provider and as an innovator in the market. Our corporate culture is based on dedication, respect, and continuous improvement. We have ventured into diverse areas in the construction industry such as Steel Building and Roofing, **Roller Doors and Roller Shutters, Sliding Gates, Swing Gates, Telescopic gates, Fire Door, Fire Shutter, High Speed PVC Doors, Clean Room Doors, Medical Doors, Barrier Gate Systems, Turnstiles, Tempered Glass, Shower Cubicles, Steel and Aluminium, Fabrications, Stainless Steel Railings, Agricultural equipments & Machineries, Diesel Storage Tanks, On-grid & Off-grid Solar Systems**. At Three Sinha, we have a clear vision for the future and understand how to react to the ever changing environment. Our goal is to provide customers with the most convenient and effective source of basic, high-quality pre-engineered and pre-fabricated steel buildings and related construction products. We develop or acquire relevant information, engineering know-how, state-of-the-art manufacturing techniques, and delivery systems continuously. Our Success is measured by how well we satisfy our customers' requirements and their success.

Embracing technological advancements and consumer needs, Three Sinha Roller Doors became synonymous with modern living. Learning through hands-on experience and overcoming failures, I upheld values of durability, customer-centric service, and quality craftsmanship. This commitment allowed us to expand, diversify, and install over 200,000 roller doors island-wide. Recognizing the importance of after-sales service, we established service centers with 24-hour technical support to maintain customer trust. We are committed to remaining accessible and responsive to them. In order to be better prepared to serve our customers, Three Sinha is investing in its employees, internal processes, tools, and business systems. We are strengthening our existing core competencies as well as investing in the development of new capabilities to meet the increasing demand of our customers.

Three Sinha strives to be recognized as an employer of choice and has established programs designed to attract and retain a highly skilled and motivated workforce. Our people are our greatest asset. We are working as hard as we can to give you the highest quality products, the best value for your money, the most convenient way to shop, and the strongest security possible. Buy your construction requirement from Three Sinha. It is the right choice. Today, Three Sinha thrives on a foundation of innovation, resilience, and customer satisfaction.

# OUR BRANCHES & FACTORIES



**Head Office & Concept Center**  
448, Nawala Road, Koswatta,  
Rajagiriya.



**Kottawa Showroom**  
318/A, High Level Road,  
Mahalwarawa, Pannipitiya.



**Negombo Showroom**  
No 504/1, Colombo Road,  
Kurana, Katunayaka.



**Kandy Showroom**  
No. 506, kurunegala Road,  
Wathuwala, Katugastota.



**Matara - Factory & Showroom**  
769, Galle Road, Madiha,  
Walgama, Matara.



**Welimada Showroom**  
No.63, AMP Building,  
Nuwara-eliya Road, Welimada.



**Rajagiriya - Factory**  
159, M.D.H. Jayawardana Mawatha,  
Maddinagoda, Rajagiriya.



**Millewa - Factory**  
96B, Millewa Industrial Zone,  
Kindelpitiya, Millewa.

# ZINC ALUMINUM POWDER COATED ROLLER DOOR



LED Touch  
Pad with  
Remote Handset



## World Class Australian Technology and Workmanship

- Remote Control - gives you the safety and convenience of opening the door right from your vehicle
- Automatic Reversing Safety System - prevents the door from damaging your vehicle and protecting your loved ones
- Open & Close buttons - help you to set the open /close limits quickly & precisely
- Manual Pull Cord - hands the control over to you, in an event of power failure
- Others - Move Up (20cm/sec): noiseless and ventilation holes are provided.
- Available in Colours and Sizes of your choice
- Robust design withstands wind & rough handling

## Automatic Reverse Function

Only from Three Sinha Roller Doors



Three Sinha Roller Doors come with an Automatic Reverse Function, So if the door comes into contact with an obstruction on its downward journey, it goes back up Automatically. Our doors also include safety features such as panel edge design and end covers in order to prevent finger entrapment between panels.

We are the only company in Sri Lanka who manufactures Roller Doors with following specifications

- ▶ 27 feet Width ▶ IDA Thickness
- ▶ 40 feet Height



Roller Door  
Inside View

Heavy Duty Roller Door  
Operator

Roller Door Control Box  
with Remote Hand Set

# POLY CARBONATE SEE THROUGH ROLLER DOOR



Three Sinha Poly-Carbonate is a man-made material that's especially suitable for roller shutters. Like glass, it's transparent, but unlike glass, it's very hard to break.

Advance Group poly-carbonate transparent roller shutter doors are of a special design with reinforced aluminum rods between the panels. The design and materials make our poly-carbonate shutters extremely strong and resistant to forced entry.

The combination of high visibility with exceptional strength makes our poly-carbonate transparent Roller shutter doors ideal for shops that want to keep valuable goods on display, such as jewelers. Also, these shutters are a good choice for premises that require a higher level of security, for example, banks.

### Suitable for

**Clubs, Hotels, Airports, Shopfront, Tenancies, Pharmacies, News Agencies, Free Standing Kiosks, Reception Areas**



# POLYCARBONATE, PERFORATED AND VENTILATION FOLDING DOORS



Shangri-La, One Galle face

Three Sinha Folding Door is the fashion representative of the Roller Door. Curtains are made from Engineering Plastics, which is made of polycarbonate (pc bullet proof rubber). The Crystal Shutter Door provides a stylish look for trendy clothing, brand monopoly, trendy mobile phones, and other trendy shops. It has a certain waterproof and windproof effect. The connecting ribs of aluminum alloy enhance the protective effect and are available in specifications such as frosted, transparent and colored. It can be used in workshops, markets, office buildings, exhibition halls, and for home decorations. It can be installed in the inner door or outer door which has the functions with thermal insulation, dustproof and noise reduction.



**Suitable for**  
**Clubs, Hotels, Airports, Shopfront, Tenancies,**  
**News Agencies, Free Standing Kiosks,**  
**Pharmacies, Reception Areas.**



# SLIDING GATES

## MOTOR & REMOTE CONTROL

Three Sinha Sliding Gate is a type of gate that opens horizontally by sliding, whereby the gate is either mounted on or suspended from a track. When there is no room for the swing of a hinged gate, the best would be to go for a Sliding Gate. It can either travel on rollers suspended from an overhead track (Top Hung) or tracks or guides along the floor.

Three Sinha Sliding Gates can be made using Galvanized Steel, Stainless Steel, Mild Steel, Aluminum or any other combination of those. The color, texture, the thickness is at the client's preference. We use the standard measures in order to prevent corrosion. The Timber we use is again treated to its best standards.

Three Sinha Sliding Gates can be doubled leaf or a single leaf. Height & width is the client's requirement. Our Automation solution can be motorized gates up to 6000kg and the width of the gate is again at the client's requirement. Gate Motors have the highest safety standards & security features. We offer high-quality products, after-sales service & warranty.

- Architecture to match any pattern
- Can be fabricated either in stainless steel or steel
- An economical option for household use
- No height restriction
- The motorizing feature with remote control can be incorporated for any existing sliding gate

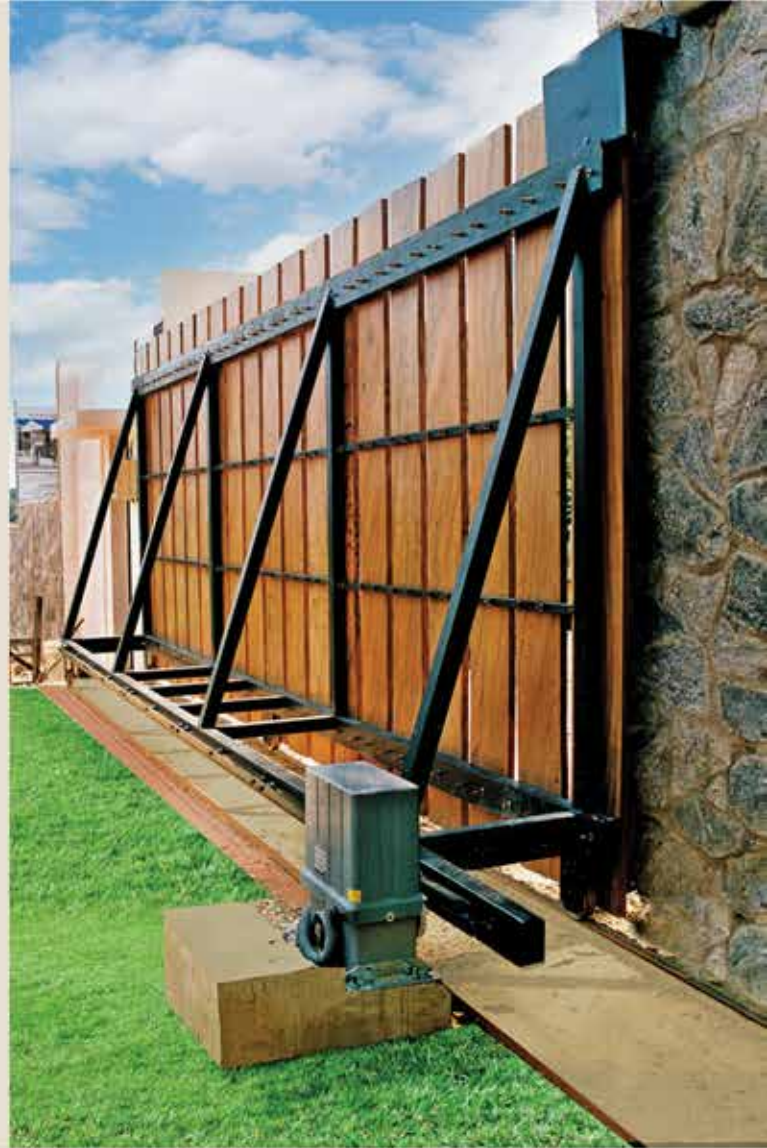

# SWING GATES

## MOTOR & REMOTE CONTROL



Automatic Swing Gates by Three Sinha are fabricated to provide safety, suitability, and defense against unauthorized invasion. These gates are artistically fabricated and are made with square pipes encased in a pipe frame, tailored to suit the client's necessities and are finished with spray paint.

- Remote control gives you the safety and convenience of opening the gate right from your vehicle
- Can be fitted to any swing gate
- Skillfully fabricated to match any complex design
- An economical option for households
- Available both in stainless steel and steel
- No noise and No height restriction

<p><b>STEEL-LINK</b> Arm Motor <small>TRUSTED PARTNER FOR YOUR DOOR</small></p> <p>SL 1500 - 2000 Photoeye Sensor Alarm Lamp SL 3500</p> <p>Sliding Gate Operators</p>	<p><b>MAG</b><sup>®</sup> MALAYSIA Floor Mount Motor</p> <p>Weatherproof Oil Bath Motor Dual speed Customizing IP</p> <p>LOW VOLTAGE <b>DC24V</b> NO Electric Hazard</p>	<p><b>STEEL-LINK</b> Floor Mount Motor <small>TRUSTED PARTNER FOR YOUR DOOR</small></p> <p><b>DEA</b> Italy Heavy Duty Arm Motor</p>
--	--	--



# ALUMINIUM AND STAINLESS STEEL RETRACTABLE GATES



Three Sinha Retractable Gates are also called Collapsible Gates; they are mainly used where large openings are needed. It is made of Stainless Steel or Aluminium. They are used as movable remote-controlled fencing options. It can be used to cover up or surround a large area in a very short period of time. The broad build makes it difficult to cross or tamper with therefore it is available in two types - with or without rail lines, depending on the customer's requirement. Stainless Steel bodies provide strength and integrity for outdoor operations.

- Available in Aluminum & Stainless Steel grade
- In Stainless Steel we have SS#201 and SS#304 grades
- It can give up to 80% Opening spaces
- Opening Time is Approx. 17 meter / Min

## Ideally used for

- Big Corporate Houses
- Factories
- Industrial Enterprises
- Stadium Main Entries
- Shopping Centers
- Shopping Malls
- Industry
- Hospitals
- Factories
- Office Apartments



## Standard Accessories:

Electric Switch R, Remote Controller, Clutch keys for manual operation with a user manual



# ALUMINIUM FABRICATIONS



Sliding Folding Doors



Casement Windows



Tempered Glass



Partitions



Shop Front



Sliding Doors



Swing Doors



Ceiling



Wall Claddings



Louvers



Curtain Walls





## Tempered Glass Shop Fronts

Shop fronts made from heat-treated tempered glass provide superior strength and safety. They resist impact and shatter into small granular pieces if broken, minimizing injury risk while maintaining a clear, modern look.



## Tempered Glass Facade

Tempered glass facades combine safety with elegance, creating visually striking building exteriors that allow ample daylight while providing enhanced durability and resistance to environmental stress.



## Tempered Glass Folding Doors

Frameless or minimally framed, these foldable doors consist of multiple toughened glass panels that fold compactly, offering versatile, space-saving solutions with modern aesthetics.



## Tempered Glass Stacking Doors

These doors glide and stack neatly to one side, creating wide, unobstructed openings. Made from strong tempered glass, they are ideal for seamless transitions between indoor and outdoor spaces.



## Tempered Glass Swing Doors

Designed with fully tempered glass for safety, these doors swing open for easy access while maintaining a clean, contemporary look suitable for commercial and residential entrances.



## Automatic Sensor Doors

These doors feature motion-sensitive technology that allows hands-free, automatic opening and closing for convenience, security, and hygiene in high-traffic areas such as offices, malls, and hospitals.

## Swing Type Shower Cubicle

A shower cubicle with a hinged swing door that opens outward or inward, providing easy access and a classic bathroom look. It is space-efficient and designed for smooth, reliable operation with tempered safety glass or durable panels.



## Sliding Type Shower Cubicle

This cubicle features a sliding door mechanism, ideal for bathrooms with limited space, as the door glides smoothly along tracks rather than swinging out. Made with tempered glass or sturdy materials, it offers a sleek, modern design and ease of use.



## Shower Screens

Shower screens are fixed or semi-fixed glass panels that prevent water splashes outside the shower area. They can be frameless or framed, available in various thicknesses of tempered glass for durability and safety, enhancing bathroom aesthetics while keeping the space dry.





## Balcony Glass Handrails

Stylish tempered glass handrails designed for balconies, offering clear views and safety with durable stainless steel or aluminum fittings, enhancing outdoor aesthetics.



## Staircase Glass Railings

Tempered glass panels used on staircases for modern, clean lines, combined with robust mounting systems for safety and visual openness indoors.



## Pool Fence

Frameless or framed tempered glass fencing that provides a secure barrier around pools, maintaining visibility while meeting safety codes to prevent accidents.



## Rooftop Handrails

Durable tempered glass handrails for rooftop terraces, designed to withstand outdoor elements, ensuring safety without sacrificing panoramic views and design elegance.





## Tempered Roof

Strong, heat-treated glass used as roofing material allowing natural light entry while providing weather resistance and structural durability.

## Canopies

Glass canopies made with tempered glass panels that protect entrances or outdoor areas with a sleek, transparent cover that blends functionality and modern design.



## Skylight Systems

Integrated skylight solutions featuring tempered glass to maximize daylight inside buildings, improve energy efficiency, and add architectural interest.

# AUTOMATIC BARRIER GATES



- Normal Barrier (Single Arm)
- Folding Barrier (90)
- Folding Barrier (180)
- Fence Type Barrier (Two-Line)
- Fence Type Barrier (Three-Line)

Three Sinha Barriers is a safe solution to stop unauthorized vehicles from accessing. They are widely used at parking lot, traffic or toll systems. The Boom Barriers are constructed with an aluminum alloy chassis. They can be mounted either left or right-hand side of the roadway. Suitable for all countries' driving & parking habit. Users can control the boom barriers arm with a remote controller or a manual button, which is very convenient. If the Automatic Boom Barriers are working with the parking systems, then the barrier will open automatically under the command from the parking system.



- Self Locking Oil Immersed Electro Mechanical Gear Motor
- Overheat & Overload
- Dual Protection
- Maintenance Free Motor
- POS wise detailed report
- Operator wise detailed report
- Total Sales Details
- Expired cards
- Re-charge card details
- Lost Cards
- Cash in and out POS wise
- Manual Operation in case of a Power Failure
- Maximum length of 6 meters
- Speedy and Silent Operation



# BARRICADE SYSTEM

- Manual Barricade
- Manual Barricade (Underground)
- Electric Barricade



# PARKING ACCESS CONTROL SYSTEM



Short Range    Medium Range    Long Range



## System Features Description

- POS wise detailed report
- Operator wise detailed report
- Total sales details
- Expired cards
- Re-charge card details
- Lost cards
- Cash in and out POS wise
- Cash settlement POS wise
- In Out detail report
- Free card user In and Out
- Manual gate opens
- User logins
- Customer card type wise report
- Operator wise summary report

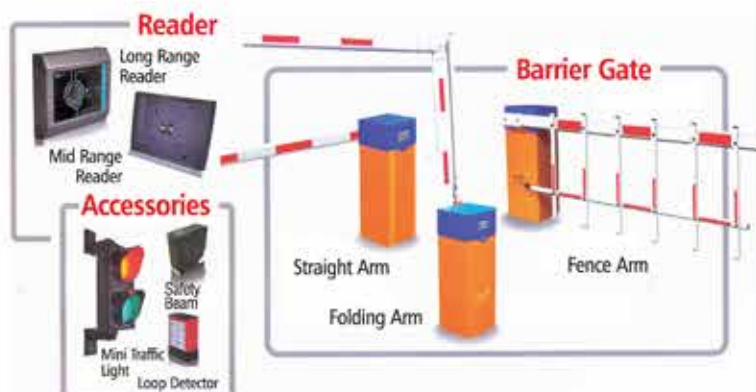

## TURNSTILE SYSTEMS

- Tripod Turnstile
- Normal Speed Swing Barriers
- Fast Speed Swing Barriers



# STEEL, STAINLESS STEEL & POLY CARBONATE CANOPIES

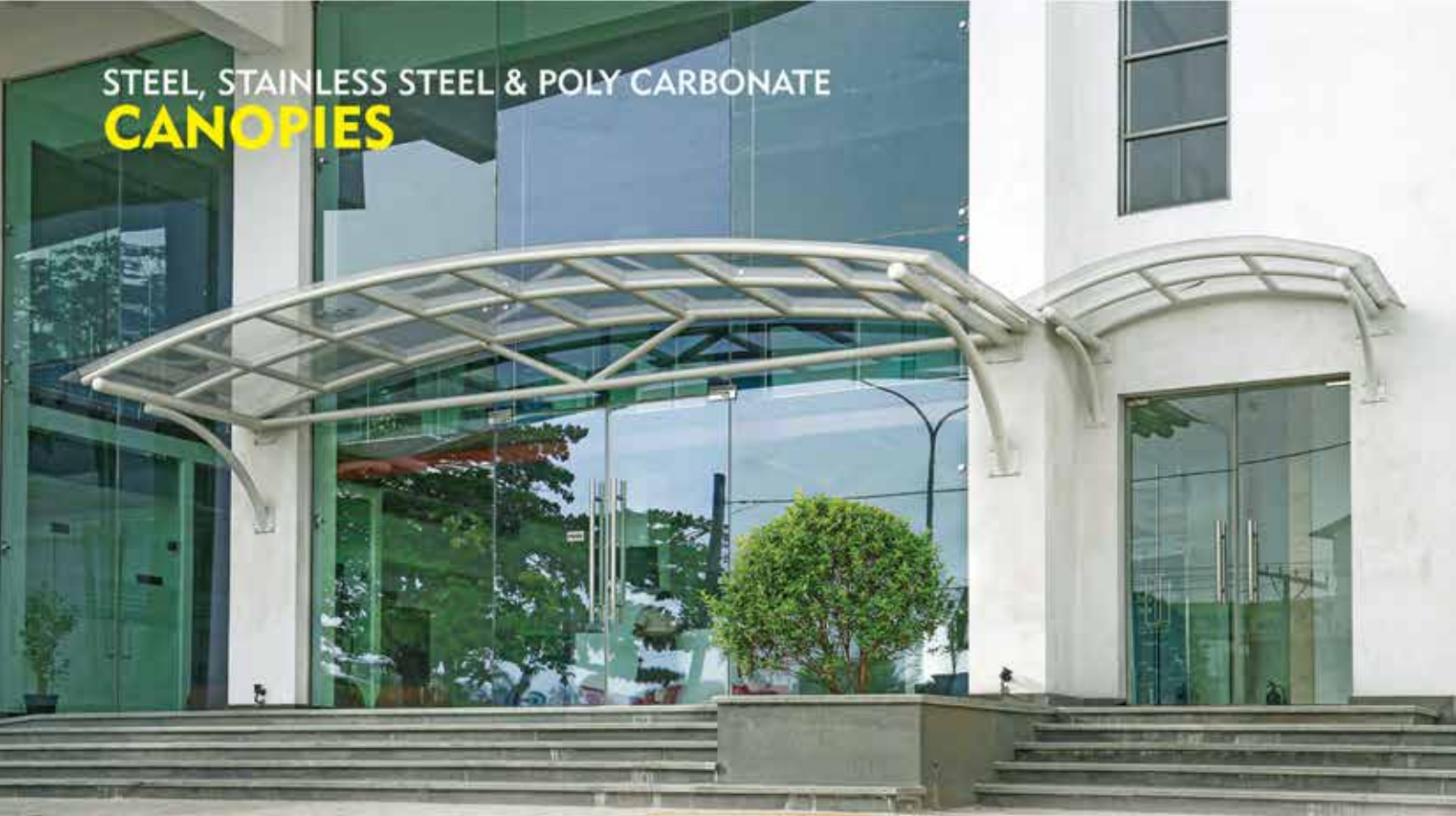

- UV filtration and cool light
- Poly carbonate thickness comes in 2mm upwards
- Available in three colours and two textures
- 10 year warranty





# Pre-Engineered Steel Buildings

Subsidiary of:



# Introduction



## Introduction

Iklo Industries stands out as a pioneering force in steel building innovation. We understand that every project – whether it's a vast warehouse, a high-performance factory, or a bespoke commercial building – has its own set of challenges. That's why Iklo doesn't just provide structures: we deliver solutions. By combining cutting-edge prefabrication methods with a highly skilled team, we offer clients exceptionally fast turnaround times without compromising on quality or design integrity.

Our philosophy is simple but powerful: build smarter, faster, and more sustainably. We believe that steel is not just a material – it's a versatile canvas that empowers architects and builders to push the boundaries of what's possible. At Iklo, every beam, joint, and panel is engineered with purpose, giving our clients flexible, cost-efficient, and future-ready buildings. In addition to our advanced steel-building capabilities, Iklo also manufactures a diverse range of high-quality products including agricultural machinery, two-wheel tractors, tractor trailers, bowsers, and heavy-duty diesel storage tanks. Our commitment to durability, efficiency, and modern engineering allows us to serve both industrial and agricultural sectors with equal excellence.





# About Us

## About Us

Iklo Industries is a leading Sri Lankan provider of prefabricated and pre-engineered steel building solutions. With over 20 years of experience, we specialize in turning architectural visions into durable, functional, and aesthetically refined steel structures. Drawing on our in-house team of expert architects, structural engineers, and project managers, we offer end-to-end services – from consultancy and design to fabrication and site erection. Iklo's modern fabrication facility combines advanced technology with rigorous quality control to deliver projects with speed, precision, and cost-efficiency.

Our parent company, Three Sinha Group, has a deep legacy in construction – and Iklo leverages this heritage to offer clients innovation, reliability, and excellence. Over the years, we have completed more than 350 projects, serving both domestic and international clients across industrial, commercial, and infrastructure sectors. We are committed to sustainability, economical design, and long-term customer satisfaction.

# Memberships



National Construction Association of Sri Lanka



The Institute for Construction Training and Development (ICTAD)



Institute of Engineers of Sri Lanka



The National Chamber of Commerce of Sri Lanka



The Ceylon National Chamber of Industries



Chamber of Construction Industry, Sri Lanka



# Advantages

- High quality, aesthetic
- Low maintenance costs
- Non combustible
- Environmental friendly
- Components can be re-used
- Components are functional
- Strong, durable and stable
- Enables good design and safety
- Sustainable to temperature effects
- Rigid and dimensionally stable
- Construction is fast compared to other materials
- Resistant to termites and other destructive insects
- Cheaper than any other construction method
- Offers fast construction

## Reduce construction time

Due to the system approach, the use of high strength steel, use built-up sections which optimized by the computerized program and the use of continuous light weight secondary steel section, there is an overall reduction in steel weight, cost and time relative to conventional steel construction.

## Design

Since pre-engineered steel buildings (PEBs) are mainly formed of standard sections and connections, the design time is significantly reduced, specialized computer analysis custom details, the light weight flexible frames offer higher resistance to seismic forces.

## Foundations

Pre-engineered steel buildings are about 50% lighter than the conventional steel structures, hence, the foundations are of simple design, easy to construct and lighter.

## Erection

All components are standard like the LEGO. The erection time is faster.

## Flexible of expansion

Buildings can be easily expanded in length by adding more bays, also, expansion in width and height is possible by pre-designing for future expansion.

## Large clear spans

Buildings can be supplied to around 90m clear spans.

## Energy efficient roof and wall systems

Buildings can be supplied with polyurethane insulated panels or fiberglass blanket insulation to achieve required "U" values.

## Lower cost

Due to the systems approach, there is a significant saving in design, manufacturing and site erection cost, the structural elements are shaped to follow the stress diagram of the member, thus reducing weight, cost and load to foundations, the secondary members and cladding nest together reducing transportation cost, the overall price per square meter may be reduced as much as 30% lower than conventional steel.

# Company Process

- **Concept Drawings**
- **Contracting**
- **Consulting**
- **Modeling & Shop Drawings**
- **Fabrications**
- **QC Checking & Packaging**
- **Delivery**
- **Erection**

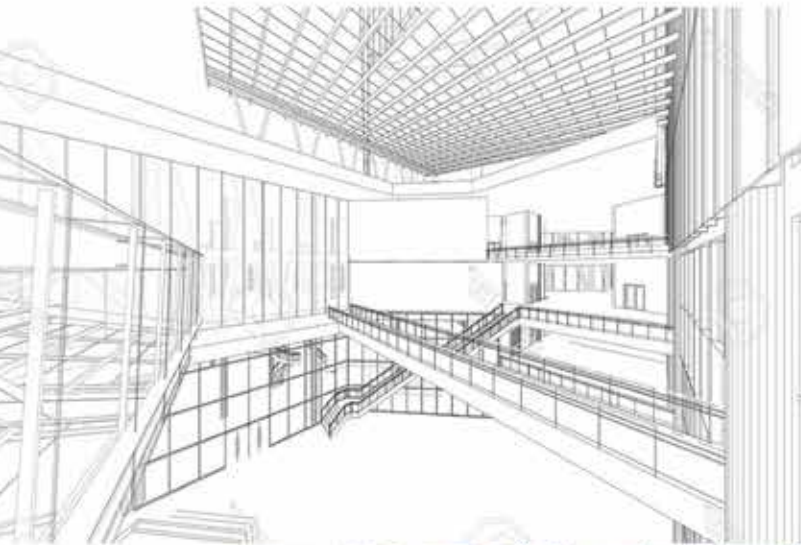

# Our Services

- **Consult & Design**

- **Manufacturing**

Cutting, Fitting up, Auto Welding,  
Manual Welding, Finishing, Painting

- **Manufacturing QA & QC**

- **Erections & Maintenance**

- **Pre Engineering H iron**

- **Pre-Fabrication of Steel Building**



# Typical Buildings Description

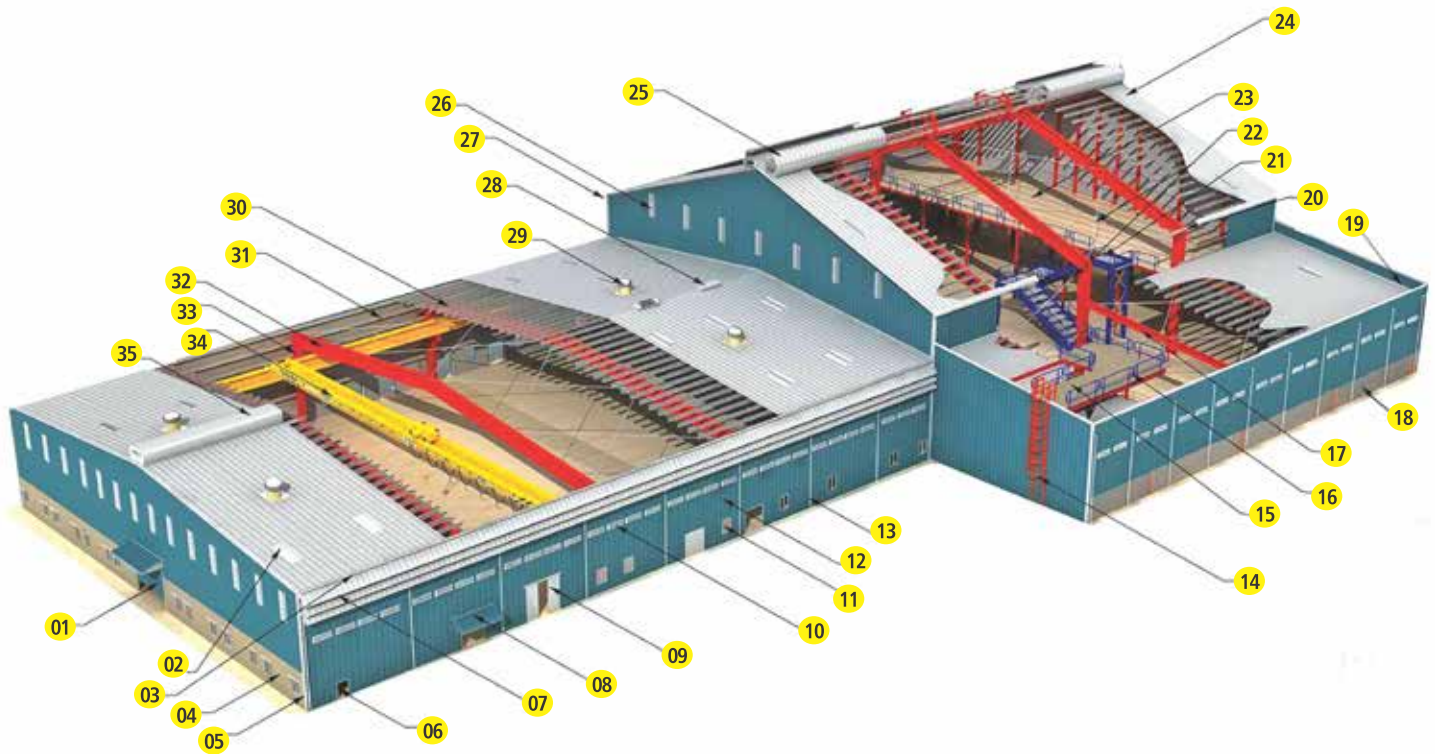

- |                        |                             |                        |
|------------------------|-----------------------------|------------------------|
| 1. Roller Door         | 13. Down spout              | 25. Gravent            |
| 2. Sky Light           | 14. Cage Ladder             | 26. Wall Light         |
| 3. Eave Gutter         | 15. Roof Platform           | 27. Curved Eave        |
| 4. Partial Blockwall   | 16. Handrail                | 28. Ridge Ventilator   |
| 5. Corner Trim         | 17. Lean to Building        | 29. Rotary Ventilator  |
| 6. Personal Door       | 18. Glazing                 | 30. Roof Purlin        |
| 7. Industrial Louvers  | 19. Parapet Fascia          | 31. Sidewall Girts     |
| 8. Canopy              | 20. Eave Strut              | 32. Rigid Frame Rafter |
| 9. Double Sliding Door | 21. Double Flight Staircase | 33. Rigid Frame Column |
| 10. Fixed Louvers      | 22. Rod Bracing             | 34. Top Running Crane  |
| 11. Alumium Window     | 23. Mezzanine               | 35. Roof Monitor       |
| 12. Wall Panel         | 24. Roof Panel              |                        |

# Product Applications

- **Factories**
- **Warehouses**
- **Stores Buildings**
- **Pavilions**
- **Workshops**
- **Aircraft Hangers**
- **Power Houses**
- **Indoor / Outdoor Stadium**
- **Multi Storied Buildings**
- **Recreation Buildings**



# Parameters & Primary Framing Systems

## Building Length

Generally maintains equal bay lengths through the building. Also can make all interior bays equal and make the end bays equal but shorter than the interior bays. 6m bay length is most economical for mezzanine floor buildings.

## Building Width

Can go upto 60m, but the square floor rate is depend on building width for clear spanned buildings. The most economical building width is 30m for larger buildings.

## Eave Height

Is the height of main columns. Can go upto 30m, but the most economical height is 6m.

## Over Hang Length

Is the width of roof beyond the structure on gable side and eave side can go up to 1m length.

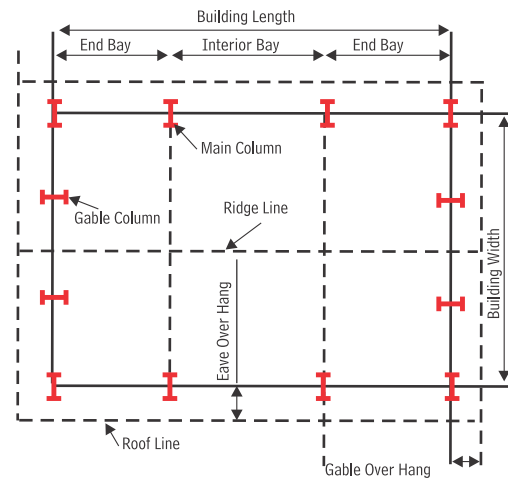

## Roof Slope

Is the angle of the roof with respect the horizontal. The most common roof slopes are 5° 10° 20°

We recommend the most economical dimensions.

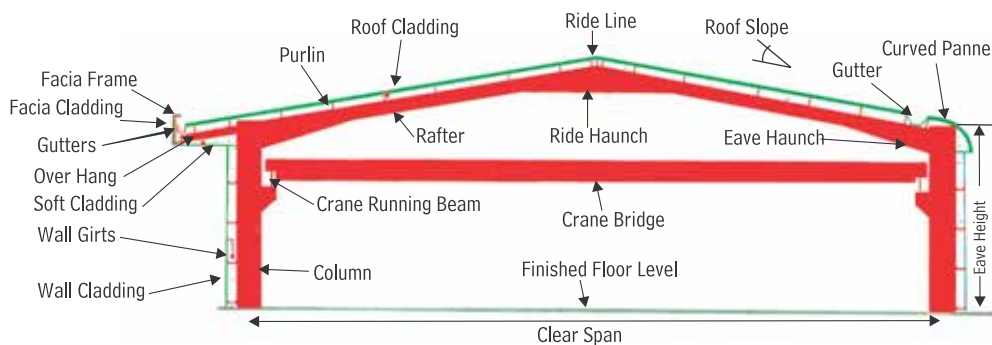

## Designing Consideration

In general, Avra steel buildings are designed to British standards. However, designs could be carried out to any other international standard or specification. Following are the standards use by Avra.

## Structural Design

BS 5950 (Part 1 to 8) 2000  
Steel designers' manual, prepared for the constructional steel research and development organization (5th edition)

## Mezzanine Floor Loads

Can be designed for deferent loads with structural decking or normal sheet decking or without decking

## Portal Frame Loads

Service Loads 0.10 KN/m<sup>2</sup>  
Dead Loads 0.10 KN/m<sup>2</sup> + weight of Rafter  
Live Loads 0.25 KN/m<sup>2</sup>  
Win Speed 120 Km/h

## Material Standard

Roller steel Joists BS 4848, Jis g3 101, SS 400  
Light Gauge BS 2989 (Roofing and Cladding)  
Purlins BS 5950  
Steel Decking BS 5950 part 1

## Crane Beams

Avra designs and supply crane beams or any other load carrying devices upto 15 tons for clear spanned building

# Parameters & Primary Framing Systems



CLEAR SPAN (CS)

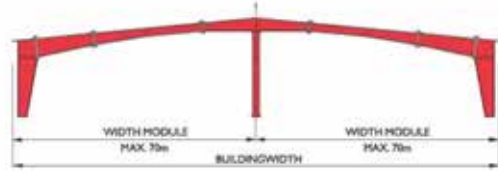

MULTISPAN "1" (MS-1)

(1 Interior Column)

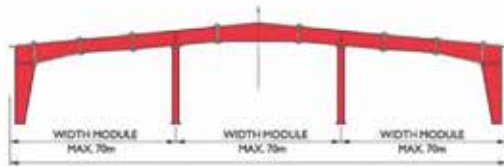

MULTISPAN "2" (MS-2)

(2 Interior Columns)

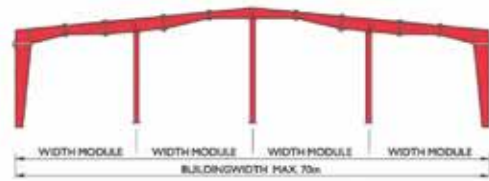

MULTISPAN "3" (MS-3)

(3 Interior Columns)



ROOF SYSTEM (RS)

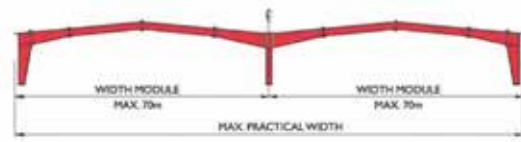

MULTIGABLE "1" (MG-1)

(1 Interior Column)



MONO SLOPE

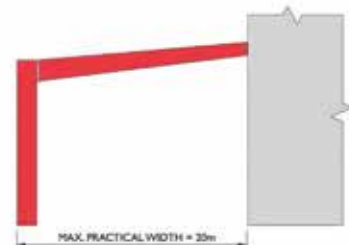

LEAN - TO (LT)

# Parameters & Primary Framing Systems

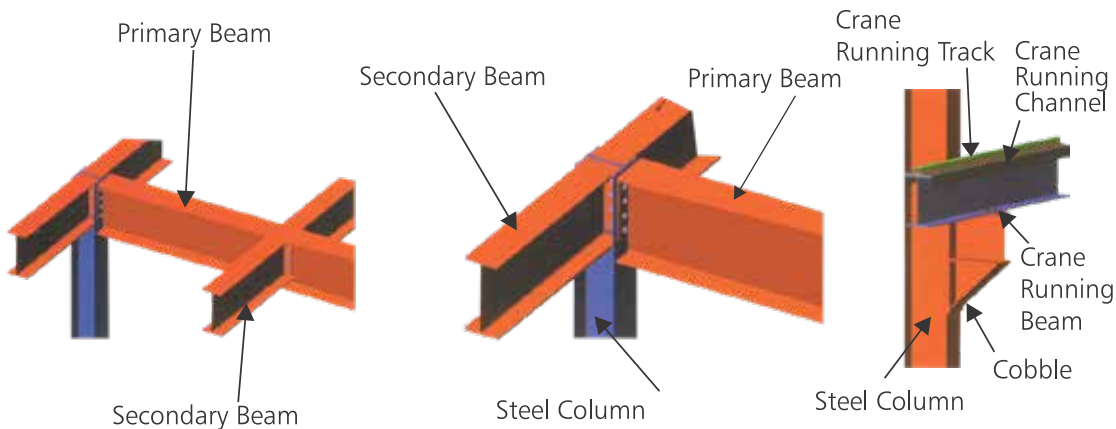

**Crane Running Beam Detail**

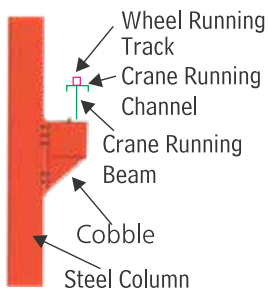

**Wall Cladding**

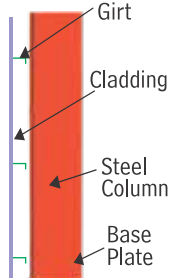

**Ridge Connecting Detail**

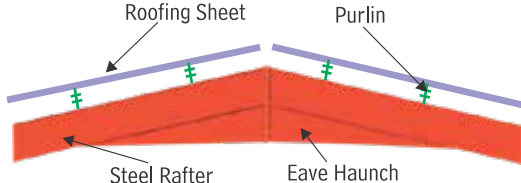

**Eave Connecting Detail**

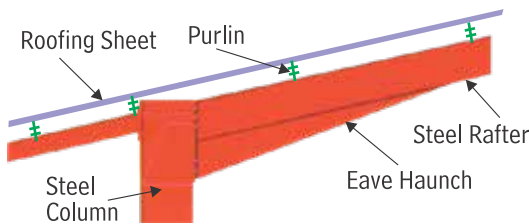

**Eave Facia Detail 1**

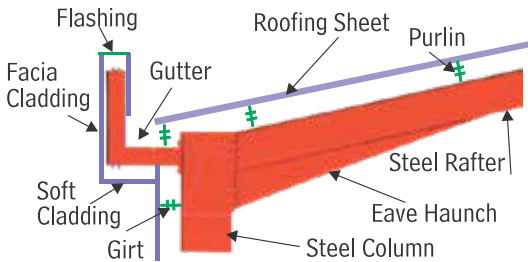

**Deck Section**

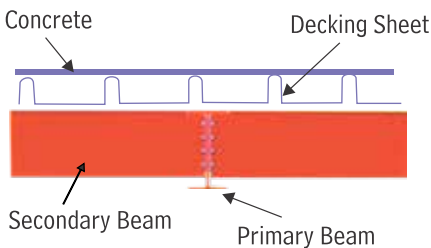

**Eave Facia Detail 2**

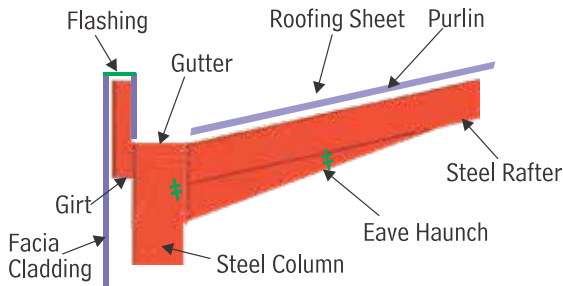

# Crane Systems

Two out of every five metal building systems are constructed for manufacturing facilities where cranes are frequently needed for material handling.

Our building can be designed to support any required crane system. Overhead travelling cranes up to 15 metric tonnes are supported on brackets. Higher capacities are usually supported by an independent support system.

A building crane is a complex structural system which consists of the actual crane with trolley and hoist, crane rails with their fastenings, crane runway beams, structural supports, stops, and bumpers. A motorized crane would also include electrical and mechanical components. Our discussion is further limited to interior building cranes.

We do require the customer's complete crane system information in order to design and estimate buildings with cranes.

The costs involved in adding a crane system to a metal building consist of:

1. Strengthening the building's main frame to support the crane loads.
2. Supplying the crane brackets and crane runway beams that support the crane system
3. Supplying and installing crane rails.
4. Supplying, installing and commissioning the crane system.

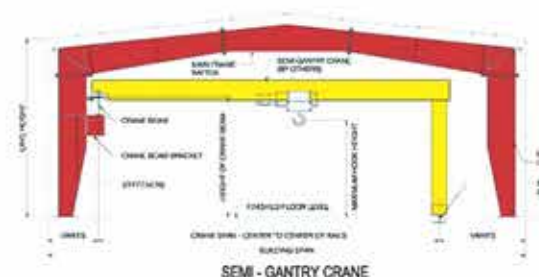
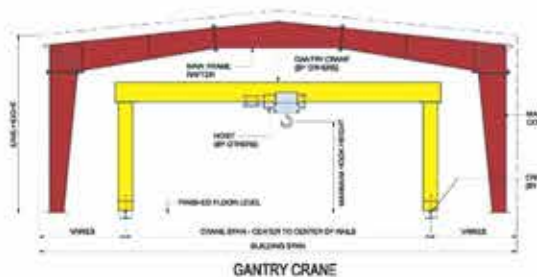
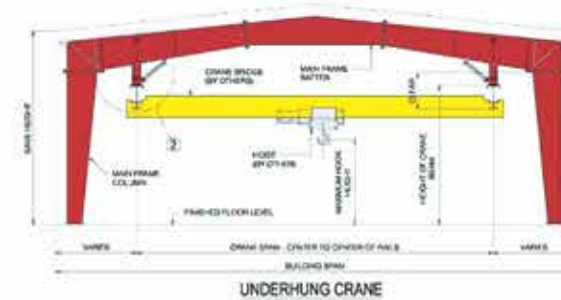
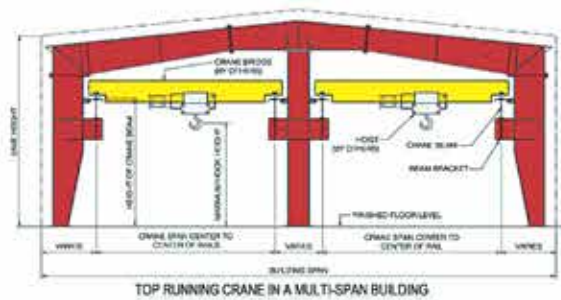

# Crane Systems

When required by design loads, the main beams shall also be supported by intermediate columns. The primary mezzanine beams usually run across the width of the building and the joists usually run lengthwise (parallel to the roof purlins). The Economy of a mezzanine system depends on the applied loads such as dead load, live load and collateral load.

Our standard Mezzanine floor systems consist of Galvanized Steel Decking Supported by joists framed onto main mezzanine beams. A reinforced concrete slab (not Supplied by US Buildings) in cast in situ on top of the metal deck with some floor finishes

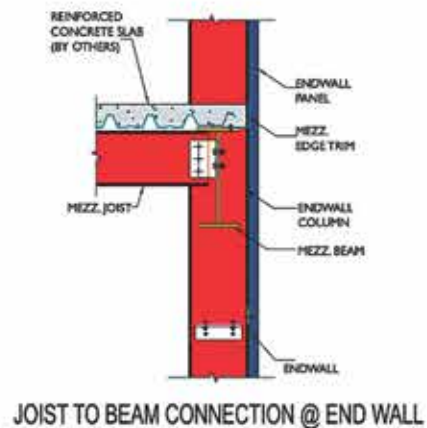
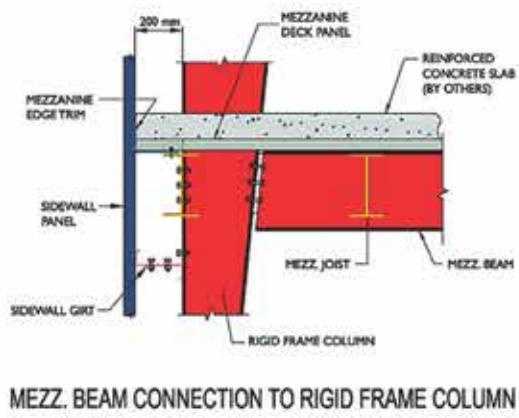
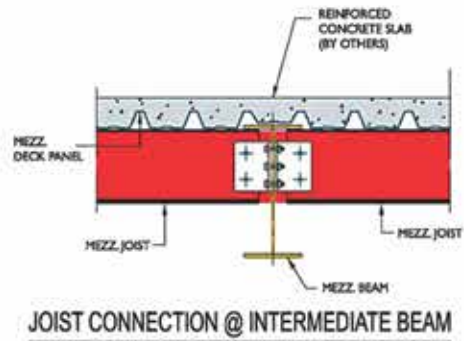

# Paint System

## Main Frame Color Range



## Panel Color Range

Standard Colors





## Our Projects

- Rathna Printers Athurugiriya
- PrintXcel Project Athurugiriya
- Domani Group Factory Building
- Hayleys Ampara
- Three Sinha Factory
- CINEC Campus - Malabe
- Chemanex PLC Factory - Mirigama
- Sinharaja Eco Lodge - Deniyaya
- Warehouse - Ja-Ela
- Tudawe Brothers
- Hayleys Fentons
- TBS International
- Management Corporation - Havelock City
- J.J. Lanka Mills - Batticaloa
- Mentored Engineering - Athurugiriya
- General Hospital - Colombo
- Bogawantalawa Tea Group - Anhettigama
- Litro Gas Lanka Ltd - Mabima
- Provincial Department of Agriculture - Puttalam



Our Projects



Our Projects

IKLO INDUSTRIES



Our Projects



Our Projects

IKLO INDUSTRIES



Our Projects

IKLO INDUSTRIES



Our Projects

IKLO INDUSTRIES

# Pre-Fabricated & Pre-Engineered Steel Buildings



Prefab steel buildings have an infinite number of advantages. The beauty of prefab steel buildings is their simplicity. A pre-engineered steel building is designed to meet all the client's requirements, specifications, and expectations to the most precise detail. A pre-fabricated steel building is pre-cut and pre-punched, and it literally comes out in the form of a kit or a large erector set.

Iklo Industries specializes in providing complete solutions, including consulting, design, fabrication, and erection of high-quality pre-engineered steel buildings and steel structure products. We offer full steel structures such as factories, warehouses, high-rise buildings, heavy industry, shopping malls, exhibition centers, and infrastructure.



## Why Should You Choose



- Complete Service
- Proven Track Record
- Team of Experts
- High Capacity
- Quick Turnaround Time
- Modern Technology





# THREE SINHA FIRE DOOR

පළමු වරට ශ්‍රී ලංකාවේම  
නිෂ්පාදනය කරන ලද ජාත්‍යන්තර  
මට්ටමේ උසස්ම ප්‍රමිතියේ

## FIRE RESISTANT DOORS & SHUTTERS



Three Sinha Steel Fire Doors are widely used in Airports, Stations, Hotels, Shopping Malls, Supermarkets, Factories, Warehouses, Underground Garages etc. Those are made of galvanized steel sheets and in fills a fireproof board.



කොළඹ ගිනි නිවීමේ සේවා දෙපාර්තමේන්තුව සහ මොරටුව විශ්ව විද්‍යාලයේ **Department of Material Science & Engineering** ආයතයේ පරීක්ෂණය කර අනුමැතිය ලැබූ පළමු හා එකම **Fire Doors & Shutters** නිෂ්පාදන ආයතනය **THREE SINHA** ආයතනය බව සතුටින් දක්වා සිටියි.

- Fire Resistant up to two hours
- Made out of steel or stainless steel
- Available in different powder coating colours
- Fire resistant view panel



Three Sinha was honored with the Fire Resistant Door "Excellence Award" under the Annual Product Award-2025 scheme, Conducted by the Sri Lanka Institute of Architects.



**THREE SINHA** AWARD WINNING

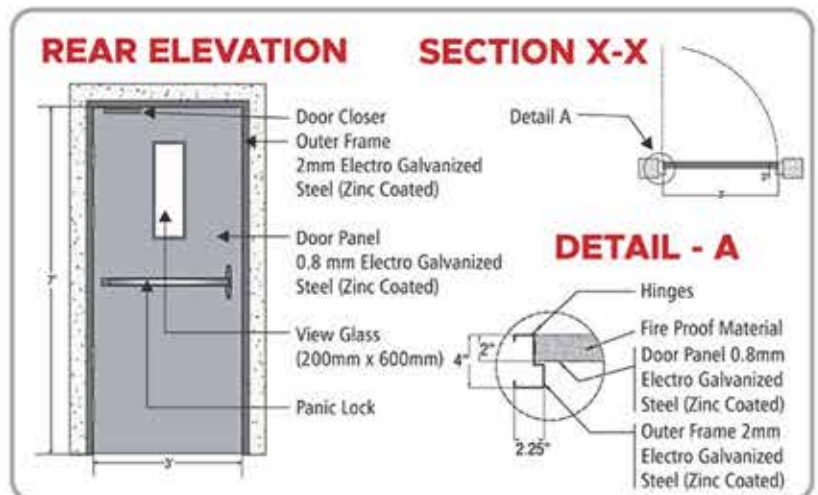

## Fire Doors & Frames – Dimensions



Door Type	STANDARD SIZE OF DOOR LEAF		
	DOOR WIDTH	DOOR HEIGHT	DOOR DEPTH
Single Door	900 mm	1950 mm	45 mm
Double Door	1900 mm	1950 mm	45 mm

# Fire Doors & Frames – Glass Selection and Finish

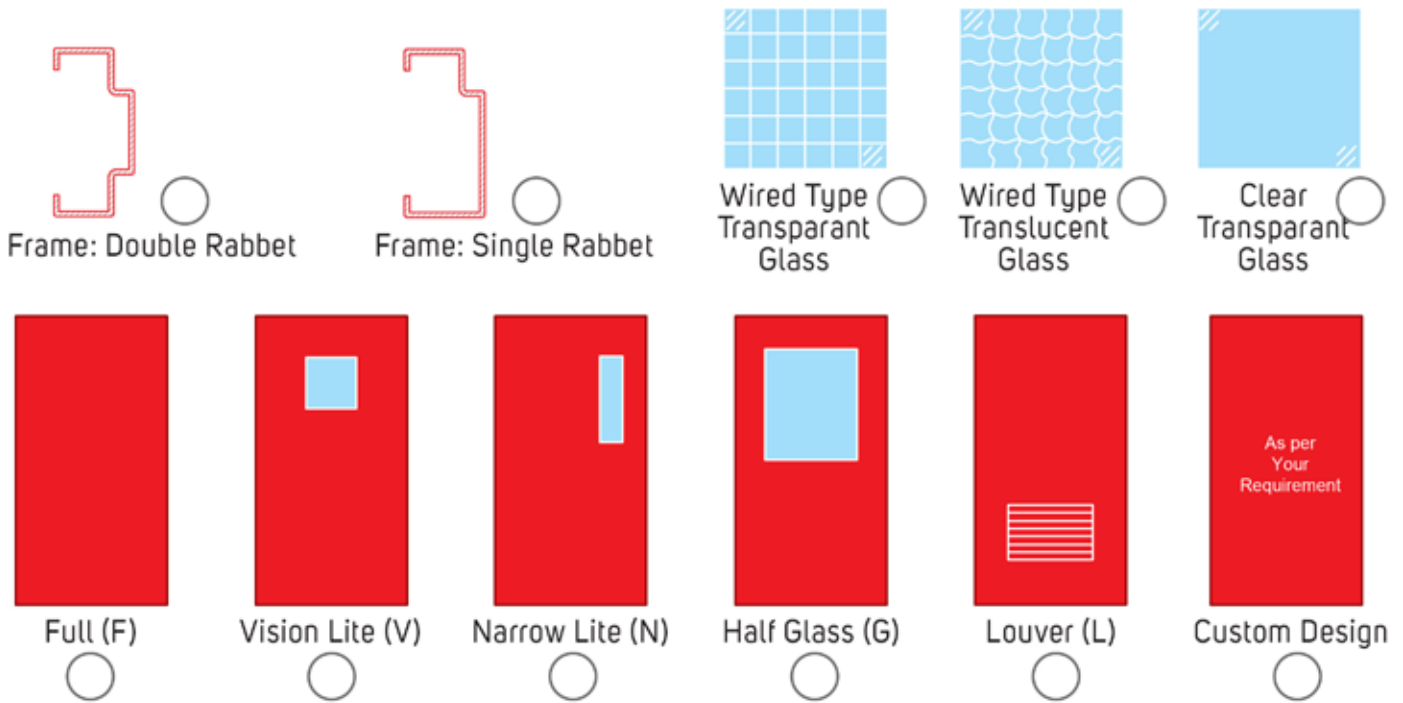

# Door Opening Type

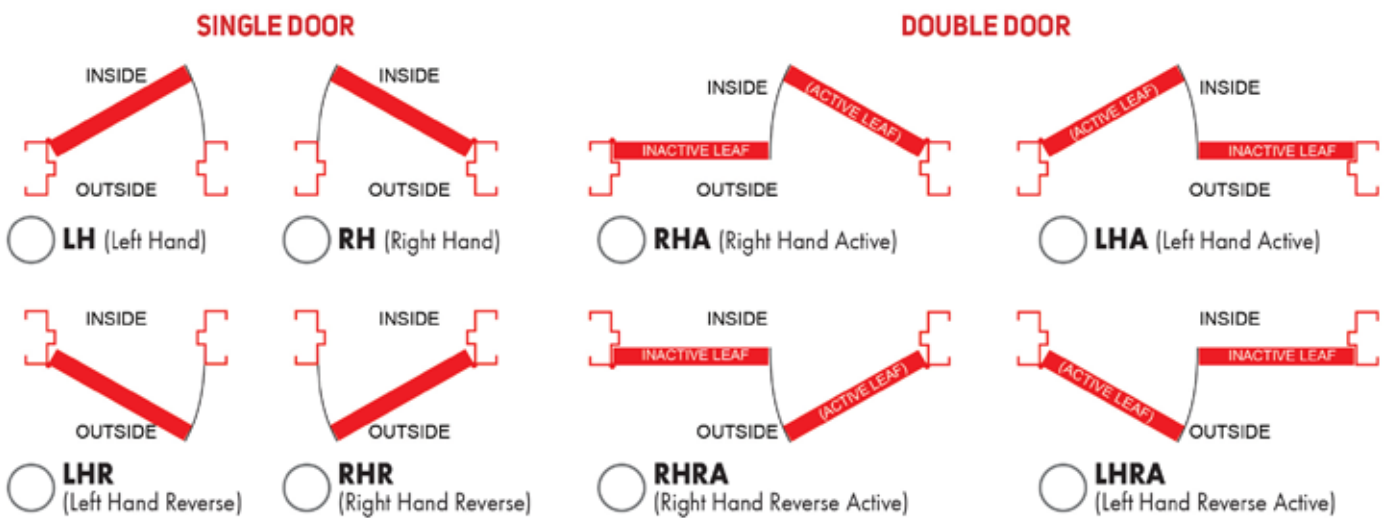





# THREE SINHA FIRE DOOR

## FIRE RESISTANT AUTOMATIC SHUTTERS



### FIRE SHUTTER ASSEMBLY

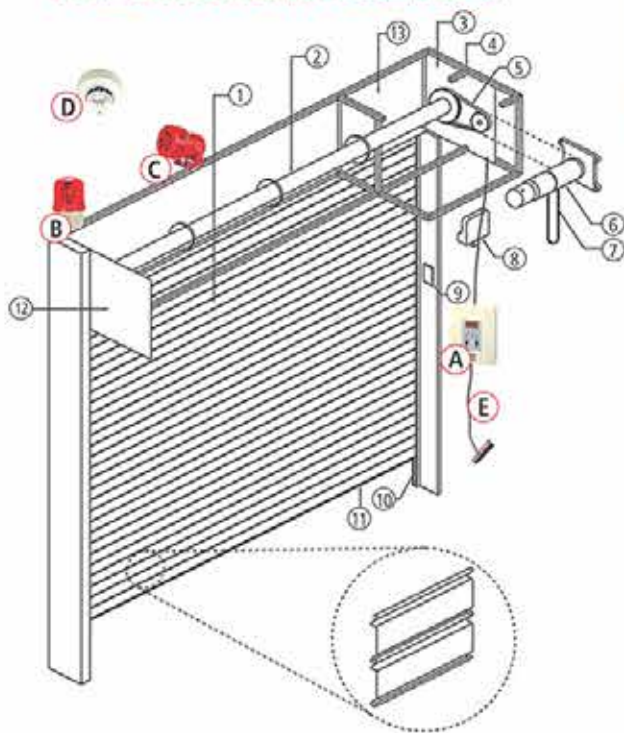

1. Shutter Panel 2. Shaft 3. Mounting Bracket 4. Motor Retaining Frame
5. Roller Chain 6. Shutter Motor 7. Manual Chain 8. Remote Sensor Unit
9. Push Button Control Set 10. 90mm Wide "U" Guide Rail 11. Bottom Bar
12. Side Cover Plate 13. Box Covered by 0.80mm Zinc Sheet



- A. Control Unit (Optional) B. Alarm Lamp (Optional) C. Siren (Optional)  
D. Smoke Detector (Optional) E. Fuse Link Cable (Optional)



Three Sinha Fire Shutter Doors are designed to prevent the spread of fire and smoke while protecting your property, products and most importantly the lives of people on the premises.

If you currently own a building or commercial property, you will no doubt already know the value of appropriate fire protection.

Three Sinha Fire Shutter Doors are suitable for all establishments, but are most effective in high risk areas such as kitchens. Products can offer optimum fire protection ranging from 1 to 2 hours.

### FIRE RESISTANT SHUTTER MOTOR



1 Solenoid Type 2 Fusible Link Type

### BRACKET SPECIFICATION CHART

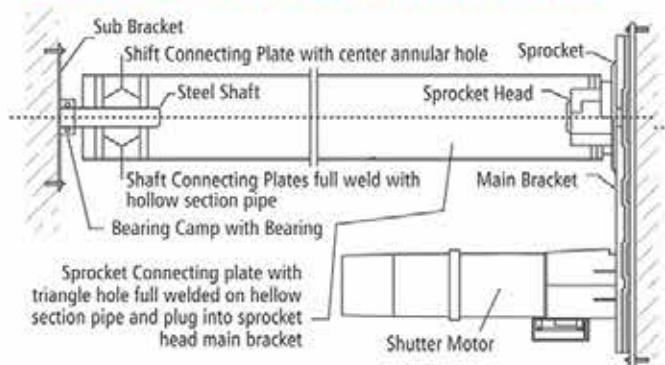

### THREE SINHA INDUSTRIES (PVT) LTD.

Head Office & Showroom - 0117 65 65 65

448, Nawala Road, Koswatta, Rajagiriya.  
Tel: 2875356, 2865427, 2883621, 2883620  
Fax: 2078058 (Marketing)



www.threesinha.lk  
marketing@threesinha.lk  
threesinha industries  
threesinha industries

#### Branches

##### Kandy

No. 506, Wathuwala, Katugastota, Kandy.  
Hot Line: 0817 65 65 65 Mobile: 0768 768 150  
E-Mail: kandy@threesinha.lk

##### Matara

769, Galle Road, Madiha, Walgama, Matara.  
Hot Line: 0417 65 65 65 Mobile: 0768 768 700  
E-Mail: matara@threesinha.lk

Hot Line  
0740 65 65 65

##### Negombo

No 504/1, Colombo Road, Kurana, Katunayaka.  
Hot Line: 0317 65 65 65 Mobile: 0768 768 600  
E-Mail: negombo@threesinha.lk

##### Kottawa

318/A, High Level Road, Mahalwarawa, Pannipitiya.  
Hot Line: 0760 65 65 65 Mobile: 0768 768 500  
E-Mail: kottawa@threesinha.lk

##### Welimada

No.63, AMP Building, Nuwara-eliya Road, Welimada.  
Hotline: 0577 65 65 65  
E-Mail: welimada@threesinha.lk

Trusted name for over 55 years among Sri Lankans



# THREE SINHA

## High Speed PVC Doors

Three Sinha PVC High Speed Doors are advanced, flexible doors designed for rapid opening and closing, typically used in industrial and commercial settings. They are constructed with durable PVC materials and powered by automated systems for efficient operations.

- PVC High Speed Doors
- PVC High Speed Doors for Cool Storage Rooms
- PVC High Speed Ventilation Doors
- PVC Self Repairing Doors



### Advantages of PVC High Speed Doors

- Improved Hygiene
- Energy Efficiency
- Enhanced Productivity
- Durability & Safety

All types of PVC doors have 3 automatic sensor systems, typically use different types of motion detection technologies to control access efficiently.

1. Microwave Radar Sensor for objects only - which only detects moving objects therefore only opens for the goods such as from a trolley or fork lift. Doesn't open for humans.
2. Microwave Radar Sensor for humans only - detects human movements but ignores objects like steel carts or forklifts.
3. Universal Sensor (For Both Objects & Humans) - Detects both human and object movement. Versatile and used in areas where both goods and personnel require access.

Each type serves a specific function to enhance efficiency, security, and automation in different environments.

### Rapid Stacking up Doors



## Medical Doors

- Medical Airtight Doors
- Anti-Radiation Airtight Automatic Doors
- Medical Hermetic Sliding Doors



**1. Medical Airtight Doors** - Specialised doors that create a secure seal to prevent air and contaminants from passing between two spaces. These doors are essential for areas where hygiene is critical. Prevents the spread of airborne contaminants, bacteria, and viruses. They are used in hospitals, laboratories, clean rooms & other areas where air control is important.

**2. Medical Hermetic Sliding Doors** - designed to ensure airtight sealing, hygiene control, and easy access in sensitive environments. Hermetic Airtight Sealing uses a

special sealing system that prevents air leakage and maintains controlled environments. Commonly used in Operating Theaters, Intensive Care Units & Isolation Wards.

**3. Anti - Radiation Airtight Automatic Doors:** Designed to shield operators from harmful stray X-rays and radiation while also ensuring airtight sealing to maintain a controlled environment. These doors are commonly used in dental clinics, radiology centers, and laboratories where radiation exposure is a concern.



### THREE SINHA INDUSTRIES (PVT) LTD.

Head Office & Showroom - 448, Nawala Road, Koswatta, Rajagiriya.  
Tel: 2875356, 2865427, 2883621, 2883620 Fax: 2078058 (Marketing)  
E-Mail: marketing@threesinha.lk

Hot Line: 0117 65 65 65

www.threesinha.lk  
threesinhaindustries  
threesinha\_industries  
/company/threesinha-industries



Let the  
**Sun Pay  
Your Bills**



### WE MAKE SOLAR EASY

We'll take care of your entire solar project from start to finish

- Free solar consultation
- Solar system designing
- Complete installation
- Solar Clearance from CEB / LECO
- CEB / LECO net meter fixing
- Commissioning with grid supply

### TOTAL SOLAR SOLUTION FOR DOMESTIC, COMMERCIAL & INDUSTRIAL

- Make Your Life With Green Energy
- Save More Money With Solar Electricity
- Quick Installation & Services
- No Maintenance Expenses

Installation will be carried out according to CEB / LECO standard and will be inspected by qualified electrical engineers of our company & qualified chartered engineers approved by institute of engineers Sri Lanka.



**In Sri Lanka under the team battle solar energy is introduced by Sri Lanka sustainability authority. This solar grid connected system is categorized into following three concepts.**

#### NET METERING

- Pay your domestic electricity bill using the solar energy units that you generate.
- Additional energy units will be deducted from your electricity bills for the next ten years.
- No monetary payments will be made.

#### NET ACCOUNTING

Pay your domestic electricity bill using the solar energy units that you generate.  
Get paid for each additional solar unit generated.

#### NET PLUS

Pay your electricity bill separately and earn money for the energy units that you generate

# OFF GRID SOLAR SYSTEMS



## OUR BATTERY BRANDS



## BENEFITS OF AN OFF-GRID SOLAR POWER SYSTEM

- Avoiding power outages
- Reducing electricity costs
- Providing an alternative power source for rural areas
- Easier installation
- A solution to the fuel problem
- Keeps the environment clean and green

## OUR INVERTER BRANDS



We offer the premium highest quality brands in the market for 100% energy security

## FREE

Quick site specific proposals with a free site visit & engineer consultation.

Panel	10
Battery	03
Inverter	01

Year  
WARRANTY

Off-Grid Systems can be purchased with or without Solar Panels

Best and most affordable Solar Power solution in Domestic & Industrial projects.



# HYBRID SOLAR SYSTEMS



Hybrid Inverter

**ON GRID & OFF GRID CAN BE USED IN ONE SINGLE SYSTEM**

## BENEFITS OF A HYBRID SOLAR POWER SYSTEM

- Can Make Your Electricity Bill Zero
- Can Say Goodbye to the power Cut
- Can Continuously use Power, No Power Interruptions
- No Need for any Fuel Requirements to Power
- Can be a Contributor to Avoid CO<sub>2</sub> Gas
- Green and Clean Energy System
- Low Maintenance Cost

### How a Hybrid Solar System Powers Your Home



# Agricultural Machinery & Equipments



## Application Benefits Of Agricultural Mechanization

- Reduction in soil erosion and more efficient use of the irrigation system targeting roots of plants.
- Due to high productivity and crop yields, commercial agriculture has developed allowing more food to be produced on a large scale, even allowing for exports.
- Has significantly reduced the effects of labor shortages in farming.
- Time & cost is significantly saved while crop yields have increased. Resulting in more income benefiting by increased profit in farms and agriculture.



Hand Tractor (12 Hp) with Standard Accessories.



Boat Tractor



Rotor Slasher with Two Wheel Hand Tractors



Rotor Slasher with Clutch Model Drive Shaft for 04-Wheel Tractors



Hand Tractor with Gang Mower



42 Blades Rotavator



8 Disc Harrow



Two Disc Plough



Nine Tine Tiller



**24/7 REPAIRS**  
YOUR RELIABLE ROLLER DOOR DOCTOR



**AFTER SALES SERVICE**

 **0117 708 708**



ROLLER DOOR



SWING GATES



SLIDING GATES

We will give you a Perfect Solution for your Door and Gate Repairs anytime, anywhere.

**We cover Doors made by Other Companies as well  
ISLAND WIDE SERVICE**

 [threesinhaaftersaleservice](#)

# OUR NETWORK



**Head Office & Concept Centre**  
448, Nawala Road, Koswatta, Rajagiriya.



**Kottawa Showroom** - 318/A, High Level Road, Mahalwarawa, Pannipitiya.



**Negombo Showroom** - No 504/1, Colombo Road, Kurana, Katunayaka.



**Kandy Showroom** - No. 506, kurunegala Road, Wathuwala, Katugastota.



**Matara - Factory & Showroom**  
769, Galle Road, Madiha, Walgama, Matara.



**Welimada Showroom**  
No.63, AMP Building, Nuwara-eliya Road, Welimada.  
Hotline: **0577 65 65 65**



**Rajagiriya - Factory**  
159, M.D.H. Jayawardana Mawatha, Madinnagoda, Rajagiriya.



**Millewa - Factory**  
96B, Millewa Industrial Zone, Kindelpitiya, Millewa.

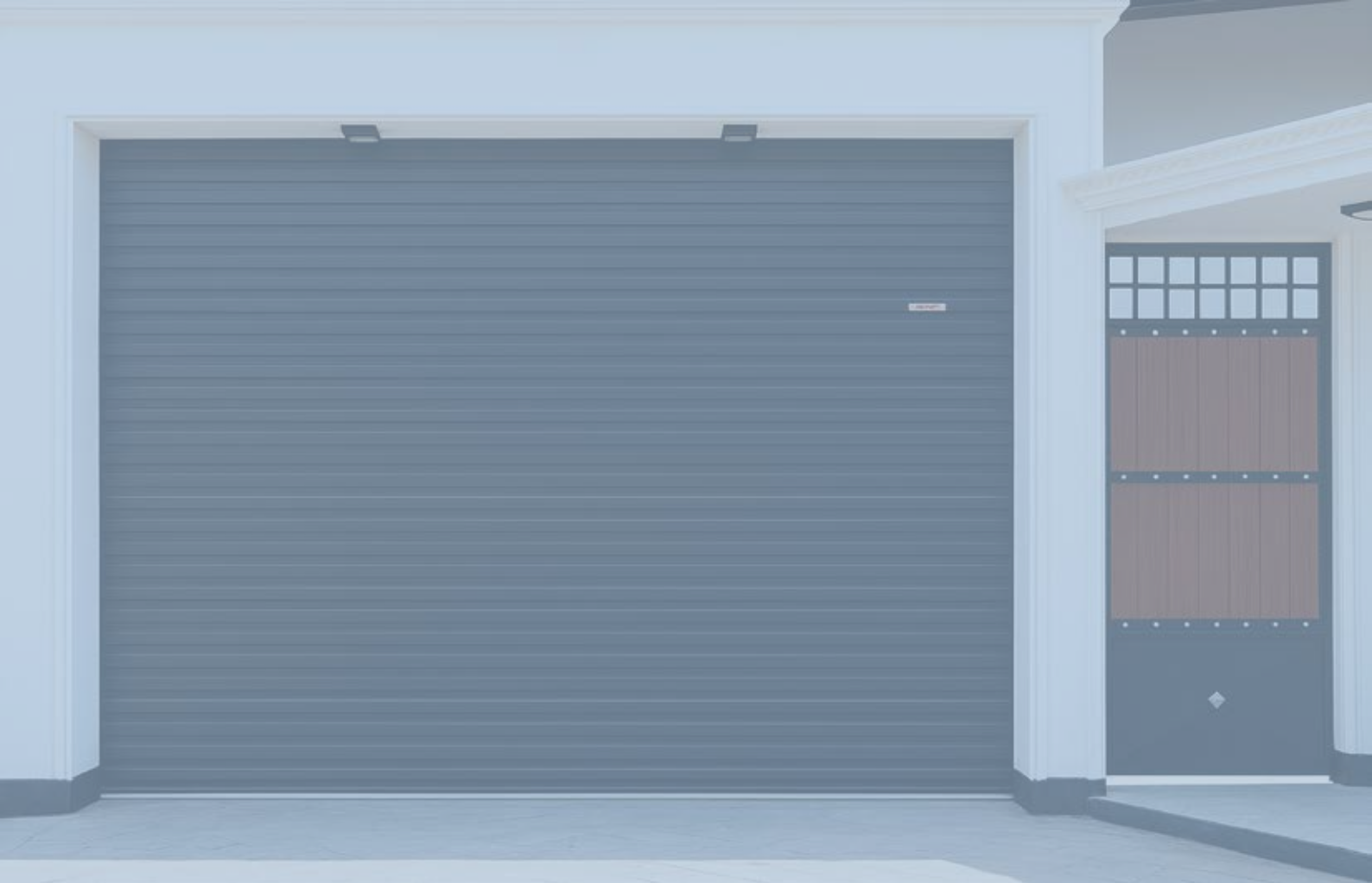

## THREE SINHA GROUP OF COMPANY

Over 60 Years In The Industry



### Head Office & Showroom -

448, Nawala Road, Koswatta, Rajagiriya.

Tel: 2875356, 2865427, 2883621, 2883620

Fax: 2078058 (Marketing) E-Mail: [marketing@threesinha.lk](mailto:marketing@threesinha.lk)

**Hot Line: 0117 65 65 65**

**Mobile: 0764 65 65 65**



### Branches

#### Kandy

No. 506, Wathuwala, Katugastota, Kandy.

Hotline: **0817 65 65 65** Mobile: **0768 768 150**

E-Mail: [kandy@threesinha.lk](mailto:kandy@threesinha.lk)

#### Matara

769, Galle Road, Madiha, Walgama, Matara.

Hot Line: **0417 65 65 65** Mobile: **0768 768 700**

E-Mail: [matara@threesinha.lk](mailto:matara@threesinha.lk)

#### Kottawa

318/A, High Level Road, Mahalwarawa, Pannipitiya.

Hot Line: **0760 65 65 65** Mobile: **0768 768 500**

E-Mail: [kottawa@threesinha.lk](mailto:kottawa@threesinha.lk)

#### Welimada

No.63, AMP Building, Nuwara-eliya Road, Welimada

Hotline: **0577 65 65 65**

E-Mail: [welimada@threesinha.lk](mailto:welimada@threesinha.lk)

[www.threesinha.lk](http://www.threesinha.lk)

[threesinha\\_industries](https://www.instagram.com/threesinha_industries)

[threesinhaindustries](https://www.facebook.com/threesinhaindustries)

[/company/threesinha-industries](https://www.linkedin.com/company/threesinha-industries)

